

**Technical Information :**

Free Speed	(RPM)	8,500
Grinding Wheel Size	Inch (mm)	7 (175)
Spindle Thread		M14 x 2.0
Air Inlet (NPT)		3/8"
Hose Size ID	Inch (mm)	3/8 (10)
Air Consumption	CFM (L/Min)	4 (113)
Length	Inch (mm)	14 (355)
Weight	Lbs (kg)	7.3 (3.3)

**WARNING**

**For your own safety, please read the operating instruction carefully before use the air tool.**

1. Please always keep the proper pressure of air inlet at 90psi (6.3kg/cm<sup>2</sup>) in order to protect your own safety and maintain the longest tool life.
2. Don't wear loose or baggy clothing when you operate the air tool.  
Remove anything that may be caused injury. For example neckties, jewelry, etc.  
Tie back long hair and wear eye protection.
3. It is the owner's responsibility to lubricate the air tool properly, but don't use any inflammable or volatile oils for lubricating, ie. Diesel oil, gasoline, or kerosene.
4. Make sure to use impact-quality sockets only, don't use hand-tool sockets. The crack of sockets will reduce the torque of air tool and may cause serious injury.
5. Don't depress trigger when connecting the air supply hose.
6. Protect the air lines from damage or puncture.
7. Never point an air tool at oneself or any other person. It could cause serious injury.
8. Keep all nuts, bolts and screws tight and ensure equipment is in safe working condition.

# Exploded Drawing

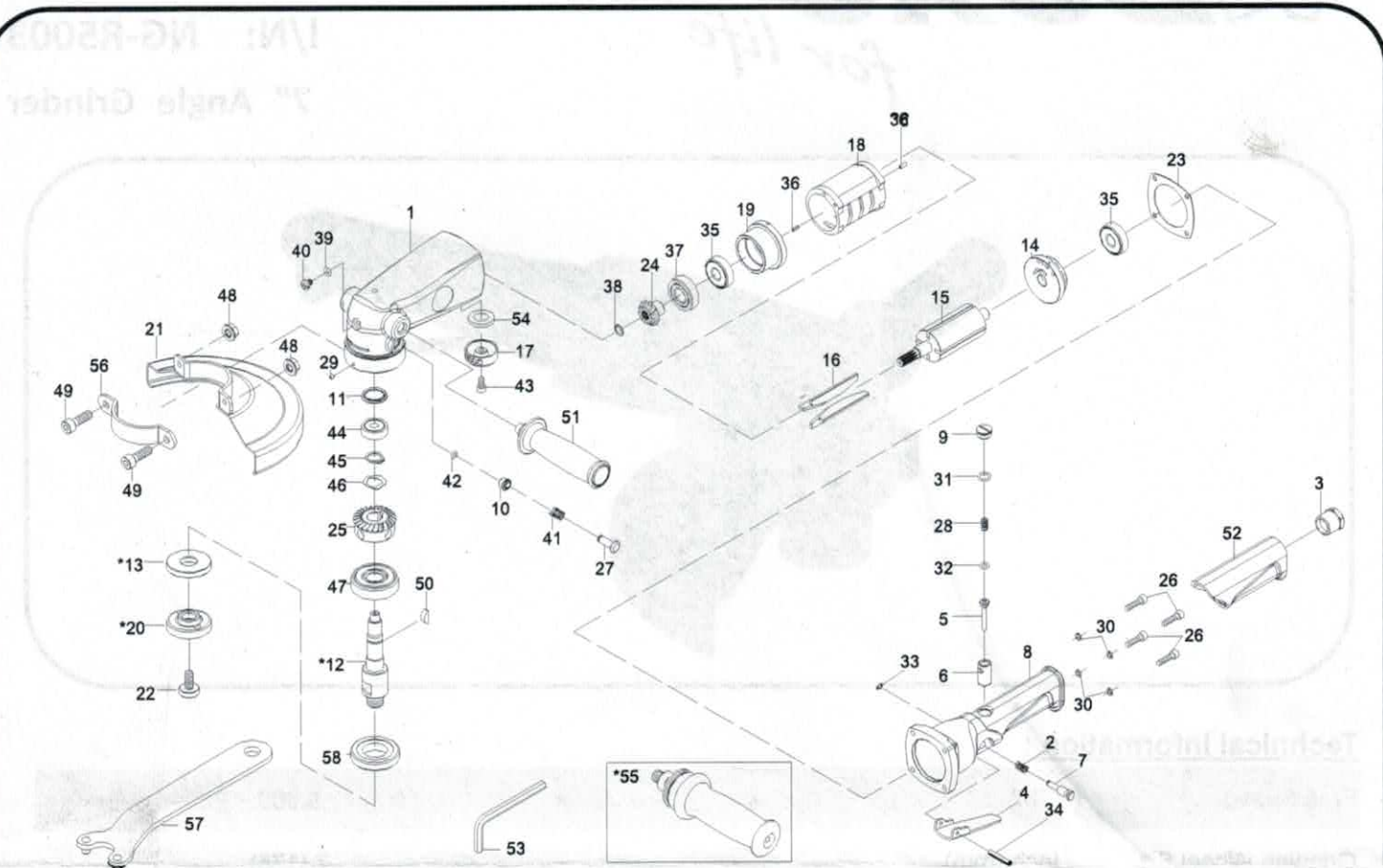

No.	Description	No.	Description	No.	Description
1	Motor Housing	*20	Flange Nut (5/8-11UNC)	40	Screw (M6x1.0P)
2	Spring		Flange Nut (M14x2)	41	Spring
3	Air Inlet	21	Disc Cover	42	O-Ring (4.47x1.78)
4	Lever	22	Screw	43	Screw (M5x10L)
5	Valve Pin	23	Gasket	44	Ball Bearing (629zz)
6	Valve Bushing	24	Pinion Gear	45	Retaining Ring (STW-15)
7	Safe Lever	25	Bevel Gear	46	Spring Washer (VW-15.5)
8	Governor Case	26	Screw x4 (M5x20L)	47	Ball Bearing (6303zz)
9	Valve Screw	27	Shaft	48	Nut x2 (M8)
10	Screw	28	Spring	49	Screw x2 (M8x25L)
11	Spacer	29	Screw (M4x0.7P)	50	Key
*12	Gear Shaft (5/8-11UNC)	30	Spring Washer x4 (M5)	51	Handle
	Gear Shaft (M14x2)	31	O-Ring (9.8x1.9)	52	Rubber Grip
*13	Flange	32	O-Ring (6x2)	53	Hex Key Wrench (6mm)
	Flange	33	E-Ring (ETW-4)	54	Damping Material
14	End Plate	34	Spring Pin (4x25L)	*55	Vibration Reduced Handle
15	Rotor	35	Ball Bearing x2 (M6201zz)	56	Retainer
16	Rotor Blade x4	36	Spring Pin x2 (3x8L)	57	Pin Wrench
17	Exhaust Deflector	37	Ball Bearing (6202zz)	58	Lock Nut
18	Cylinder	38	Retaining Ring		
19	Front End Plate	39	O-Ring (4.9x2.2)		