

TC350 TURF CUTTER

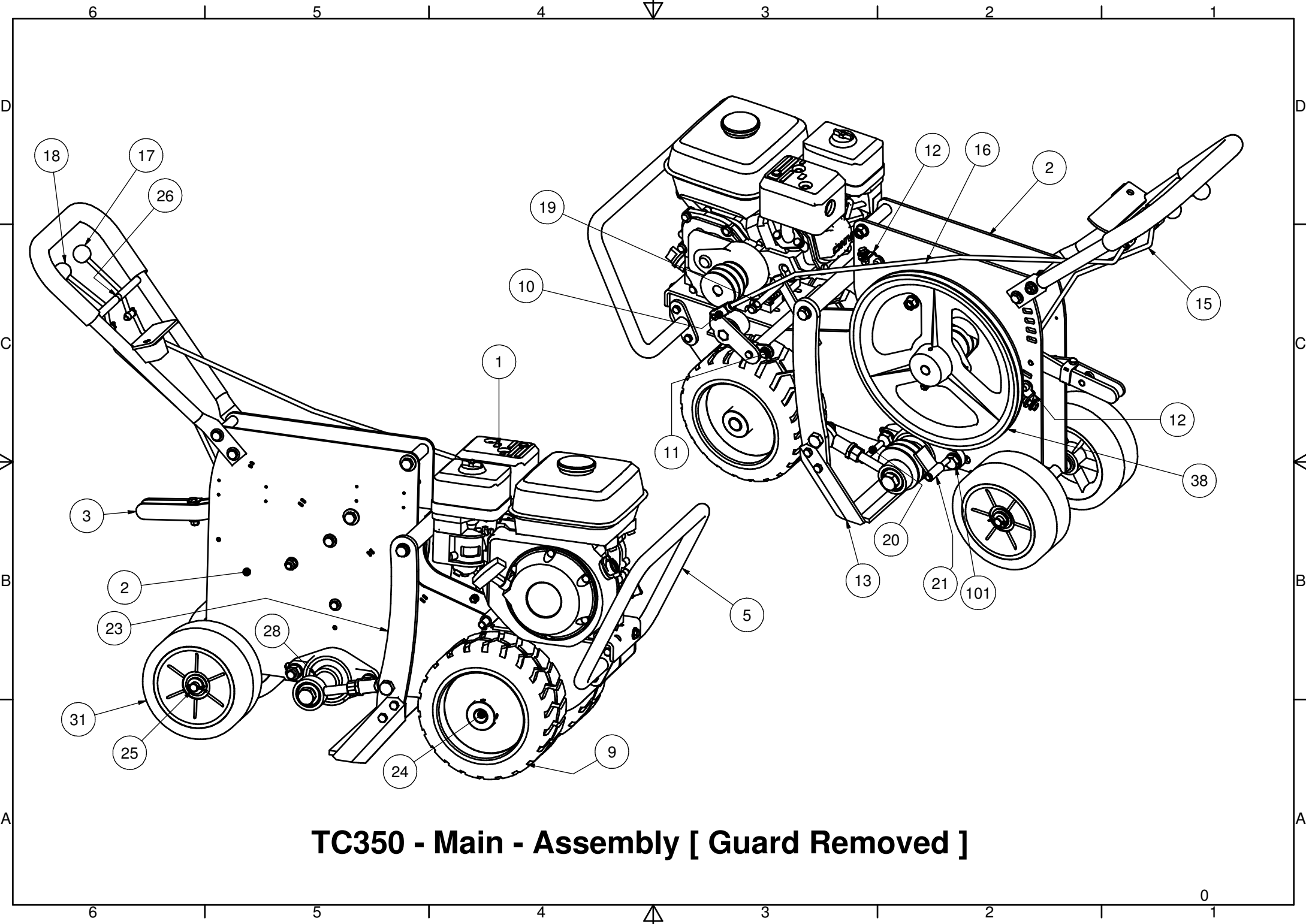

TC350 - Main - Assembly [Guard Removed]

Parts List			
ITEM	QTY	DESCRIPTION	PART NUMBER
1	1	GX160 - UT1LX2 [5.5hp]	0503-0007
2	1	TC350 - Main Body - Weldment	0605-0043
3	1	TC350 - Depth Control Handle - Assembly	0801-0027
4	1	TC350 - Belt Adjust - Engine Mount Bar - Weldment	0202-0006
5	1	TC350 - Bumber Bar - Weldment	0704-0058
6	1	TC350 - Cutter Engagement Swing Arm - Assembly	N/A
7	1	TC350 - Wheel Engagement Swing Arm - Assembly	N/A
8	1	TC350 - Handle - Assembly	0801-0022
9	2	TC350 - Front Wheel - Assembly	2305-0018
10	2	TC350 - Pull Rod Linkage - Clip - Assembly	2507-0007
11	1	TC350 - Belt Guard Front Mount - Weldment	0214-0126
12	2	TC350 - Belt Guard Bracket - Assembly	0214-0125
13	1	TC350 - Blade Turf Cutter - Weldment	0206-0023
14	2	TC350 - Crank Arm Assembly	N/A
15	1	TC350 - Pull Rod Wheel Engagement - RH Side - Weldment	1808-0031
16	1	TC350 - Pull Rod Cutter Engagement - LH Side - Weldment	1808-0032
17	1	TC350 - LH Side Cutter Drive Engagement - Assembly	0801-0024
18	1	TC350 - RH Side Wheel Drive Engagement - Assembly	0801-0026
19	1	TC350 - Belt Guide - Upper Cutter Drive Pulley - Weldment	0705-0013
20	1	TC350 - Belt Guide - B - Assembly	0705-0012
21	1	TC350 - Belt Guide Plate - B - Assembly	0705-0014
22	1	TC350 - Belt Guide - Front Wheel - Weldment	0705-0011

Parts List			
ITEM	QTY	DESCRIPTION	PART NUMBER
23	2	TC350 - Side Swing Arm Blade Holder	0102-0016
24	1	TC350 - Front Axle	1904-0030
25	1	TC350 - Rear Axle	1904-0029
26	1	TC350 - Pivot Bar For Controls	1904-0032
27	2	TC350 - Countershaft - Eccentric Boss	1913-0028
28	1	TC350 - Countershaft	1904-0027
29	1	TC350 - Guard Belt	0704-0055
30	1	TC350 - Bush - Depth Control Pivot	0215-0041
31	4	TC350 - Back Wheel - PRA 200	N/A
32	1	TC350 - Swing Shaft - Side Arms	1904-0025
33	1	TC350 - Small Wheel Drive Pulley	1608-0041
34	1	TC350 - Counter Shaft Pulley	1608-0040
35	1	TC350 - Engine Pulley	1608-0042
36	1	TC350 - 1A 14inch Pulley Shaft	1904-0031

Parts List			
ITEM	QTY	DESCRIPTION	PART NUMBER
38	1	1A 14inch Pulley	1608-0031
39	1	2A 8inch Pulley	1608-0038
40	2	UC204-12	Radial insert ball bearings
41	2	AST_Bearings_UCFL204-12	
42	2	AST_Bearings_UCFL205	
43	2	AST_Bearings_UCFL208	
44	1	10 80 6481 1016	
45	1	AS 1112 - M16 Type 9	ISO metric hexagon nuts, including thin nuts, slotted nuts and castle nuts
46	2	BS 3673/1 - B050M	Specification for retaining rings- Carbon steel circlips
57	7	AS 2465 - 5/16 x 3/4 UNC	Unified hexagon bolts, screws and nuts (UNC and UNF threads)
58	3	AS 1968 - 1976 - 8	Helical spring lock washers (metric series)
59	11	AS 1237 - 8 mm	Flat metal washers for general engineering purposes (metric series)
60	4	AS 2465 - 5/8 x 2 UNF	Unified hexagon bolts, screws and nuts (UNC and UNF threads)
61	8	AS 1237 - 14 mm	Flat metal washers for general engineering purposes (metric series)
62	2	AS 1968 - 1976 - 16	Helical spring lock washers (metric series)
63	2	AS 2465 - 5/8 UNF	Unified hexagon bolts, screws and nuts (UNC and UNF threads)
64	4	5_8 UNF - Nyloc	Unified hexagon bolts, screws and nuts (UNC and UNF threads)
65	2	AS 2465 - 3/4 x 2 UNF	Unified hexagon bolts, screws and nuts (UNC and UNF threads)
66	1	AS 1252 - M12 x 30	High - strength steel bolts with associated nuts and washers for structural engineering
67	1	AS 1237 - 12 mm	Flat metal washers for general engineering purposes (metric series)
68	1	M12 Nylock Nut	

Parts List			
ITEM	QTY	DESCRIPTION	PART NUMBER
69	4	AS 2465 - 3/8 x 1 1/4 UNF	Unified hexagon bolts, screws and nuts (UNC and UNF threads)
71	4	3_8 UNF - Nyloc	Unified hexagon bolts, screws and nuts (UNC and UNF threads)
72	2	AS 2465 - 1/2 x 1 1/2 UNC	Unified hexagon bolts, screws and nuts (UNC and UNF threads)
73	4	AS 1968 - 1976 - 14	Helical spring lock washers (metric series)
74	2	AS 1110 - M10 x 25	ISO metric hexagon precision bolts and screws
75	3	M10 Nylock Nut	
76	5	AS 1237 - 10 mm	Flat metal washers for general engineering purposes (metric series)
78	1	AS 1111 - M10 x 110	ISO metric hexagon commercial bolts and screws
79	2	AS 2465 - 1/2 x 4 UNF	Unified hexagon bolts, screws and nuts (UNC and UNF threads)
82	2	AS 2465 - 1/2 UNF	Unified hexagon bolts, screws and nuts (UNC and UNF threads)
84	7	5_16 UNC - Conelock	Unified hexagon bolts, screws and nuts (UNC and UNF threads)
85	1	AS 2465 - 7/16 x 4 1/2 UNF	Unified hexagon bolts, screws and nuts (UNC and UNF threads)
86	2	AS 2465 - 7/16 x 1 1/2 UNF	Unified hexagon bolts, screws and nuts (UNC and UNF threads)
88	5	AS 1968 - 1976 - 12	Helical spring lock washers (metric series)
90	3	AS 2465 - 7/16 UNF	Unified hexagon bolts, screws and nuts (UNC and UNF threads)
91	1	AS 1111 - M8 x 100	ISO metric hexagon commercial bolts and screws
92	1	M8 Nylock Nut	
94	6	BS 4320 - M14 (Form F)	Black metal washers - Metric series
95	2	AS 1236 - 4 x 25	Split cotter pins (metric series)
96	1	AS 2465 - 5/16 x 1 UNF	Unified hexagon bolts, screws and nuts (UNC and UNF threads)
97	2	AS 1237 - 8	Flat metal washers for general engineering purposes (metric series)
98	1	AS 1110 - M8 x 50	ISO metric hexagon precision bolts and screws
99	1	AS 1112 - M8 Type 5	ISO metric hexagon nuts, including thin nuts, slotted nuts and castle nuts
100	4	AS 2465 - 5/16 x 1 1/2 UNC	Unified hexagon bolts, screws and nuts (UNC and UNF threads)
101	1	TC350 - Belt Guide - Lower Driven Pulley - Weldment	