

Model YDC-8B1 Basket Stretcher

Manufacture Licence No.:Jiangsu SFDA Registration Certificate For Medical
Device Registration No.2001-0146

Registration Standard: YZB/Jiangsu(Jiangsu) 0204-2008

Registration No.: Jiangsu SFDA Registration Certificate For Medical Device
Registration(2008) No.1560187

Authorized By: ISO9001, ISO13485,CE, FDA,

User's Manual

PLEASE READ THE INSTRUCTIONS CAREFULLY BEFORE USING THE
BASKET STRETCHER!

JIANGSU RIXIN MEDICAL EQUIPMENT CO.,LTD

I. **INTRODUCTION**

I 1.PRESENTATION OF THE MANUAL

This manual is a part of the article to which it is referred. Please read the instructions carefully as they provide important information on SAFETY DURING USE AND MAINTENANCE PROCEDURES.

Descriptions and images contained in the publication are not binding; “RED LEAF” has the right to modify any information for enhancement purposes without any obligation to update this manual.

Graphics and images contained in this manual are only examples and may improvement of products.

I 2.MANUFACTURER INFORMAION

Manufacturer: Jiangsu Rixin Medical Equipment Co., Ltd.

Address: Yangjin Road, Jinfeng Town, Zhangjiagang City, Jiangsu Province, China 215626

Sales(Tel): [Tel]:0512-58500800 [Fax]:0512-58516911

Service(Tel):+86-512-58516902

Web: [Http://www.rxyl.com](http://www.rxyl.com)

E-mail: xs@rxyl.com

I.3. IDENTIFICATION MARK

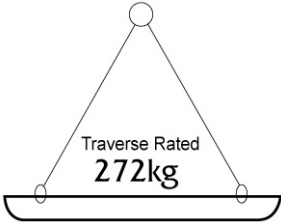
	RED LEAF	ISO9001, ISO13485, FDA, CE
		
NAME: BASKET STRETCHER	MANUFACTURER: JIANGSU RIXIN MEDICAL EQUIPMENT CO.,LTD	
MODEL: YDC-8B1	ADD: YANGJIN RD,JINFENG ZHANGJIAGANG JIANGSU CHINA	
JIANGSU SFDA REGISTRATION CERTIFICATE FOR MEDICAL DEVICE REGISTRATION(2008)No.1560187		
YZB/Jiangsu(Jiangsu) 0204-2008		
TEL: 0512-58500800	WEB: www.rxyl.com	

I.4. FEATURES

Model of YDC-8B1 basket stretcher was made with an eye on a very wide range of emergency situations and, as it is sturdy and flexible to use, it is a must for all types of aid in special situations. You can split it into two parts, making it compact and easy to transport. It's quick reliable fittings enable first-aid personnel to operate rapidly and safely. With its special sling equipment, the stretcher is ideal for lifting and transport by helicopter. It has an adjustable feet-securing mechanism, safety belts and a mattress. It is also designed for to be secured inside the helicopter.

I.5. REGISTRATION STANDARD

Model YDC-8B1 was design and produce by “ RED LEAF”, authorized by China SFDA and Europe EEC/93/42 instructions.

All the materials used have dimensions suitable to work and they are fire-proof, they do not release any toxic or polluting substances and they are protected to obtain high resistance to wear and corrosion.

I.6. PRESCRIBED USE

Transport of injured patient.

Use NOT conforming to that described in this manual is forbidden.

I.7. CUSTOMER SERVICE

The customer and product assistance services are important parts of “RED LEAF” company structure. “RED LEAF” is the only authorised agent for the management, assistance service and repair of the “RED LEAF” products. If you need to order spare parts, take note of the product type, the serial number and the part number of the basket stretcher. This will allow “RED LEAF” to give you faster and better quality assistance. The customer service is at your disposal for further information on use, maintenance and service of these products.

II. SAFETY

II.1 GENERAL RULES

1. Operators must read this manual carefully, follow the instructions and familiarise with the correct operating and maintenance procedures of the stretcher.
2. The stretcher can be operated by two average height persons in good physical conditions. In particular operators must possess sufficient strength in their back, arms and legs to lift, pull and push in addition to good physical balance, reflexes and muscular co-ordination.
3. Unusual circumstances or excessive weight of the patient can require additional personnel to ensure comfort and safety to the patient.. Always tell the patient when you adjust the stretcher. Never leave the stretcher unattended if a patient is sitting on it.
4. Improper use or maintenance can be harmful to people or objects. Always use and maintain the stretcher as prescribed by this manual.
5. Use only “RED LEAF” spare parts and service. Keep this manual for reference and to support personnel training. Transfer it together with the product if you sell or give the product to new users.

WARNING! IN CASE OF BLOOD TRANSMITTED DISEASES: To reduce the risk of exposure during use, follow the maintenance instructions contained on personnel safety established by the person in charge of the Medical Emergency Service.

III. GENERAL DESCRIPTION

III.1 TECHNICAL SPECIFICATIONS

WARNING! DO NOT EXCEED THE SPECIFIED WORKLOAD; THIS CAN CAUSE DAMAGE TO THE PATIENT AND/OR TO THE STRETCHER.

III.2 NAMES OF MAIN PARTS

- | | | |
|-----------------------------|------------|-------|
| 1) Belts and carrying bag | (BS002) | 4 pc |
| 2) Ring attachment facility | (8A/B014) | 4 pc |
| 3) Stretcher | | 1 pc |
| 4) Feet securing board | (8A/B018) | 1set |
| 5) Helicopter sling | (8A/B010) | 1 set |
| 6) Hooks | (8A/B019) | 4 pc |
| 7) Safety belts | (8A/B0101) | 4 pc |
| 8) Bottom spring pins | (8B1011) | 1pc |
| 9) Bottom connect pins | (8B1010) | 1pc |
| 10) Nearside spring pins | (8B1011) | 2pc |
| 11) Nearside connect pins | (8B1009) | 2pc |

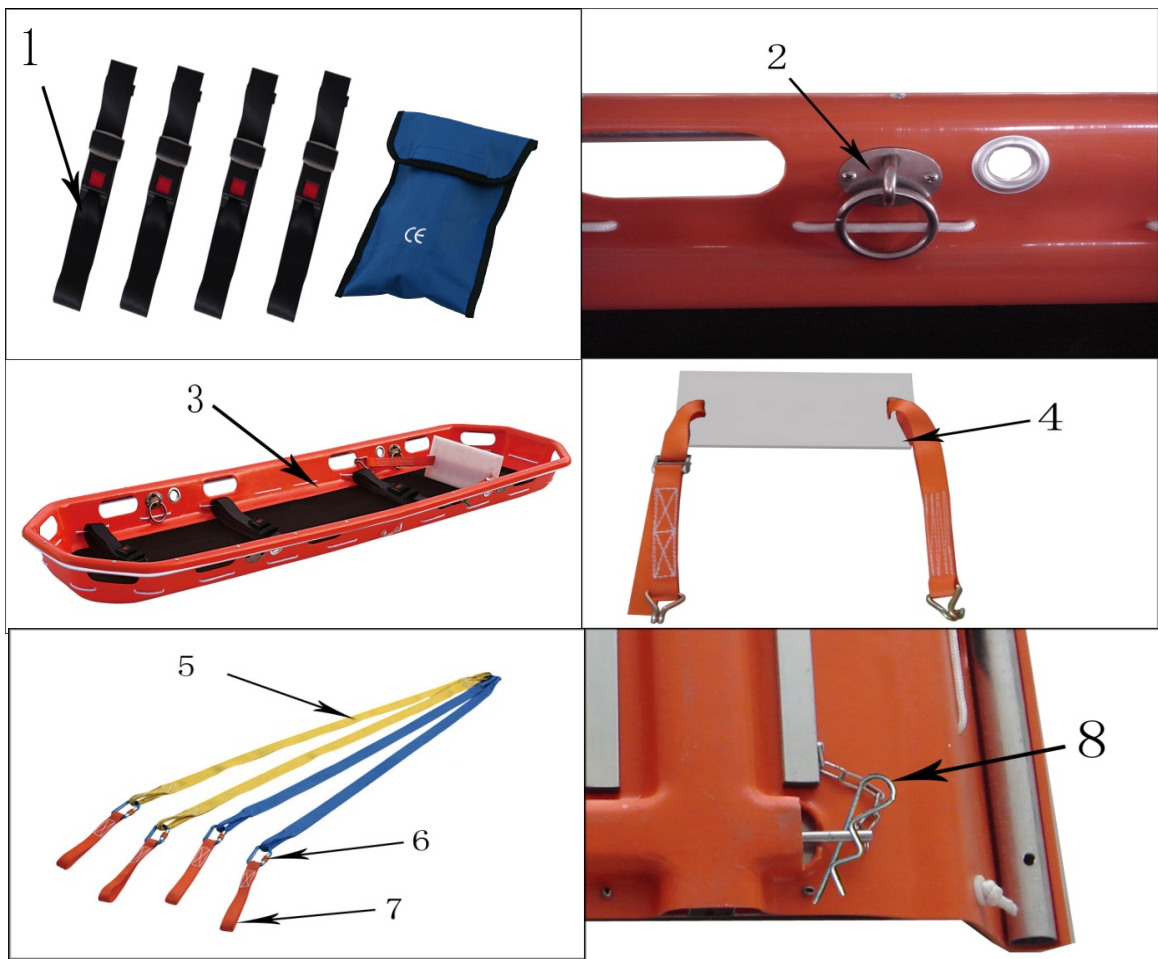

IV. OPERATION

IV.1 TRANSPORT AND HANDLING

WARNING! LIFTING AND HANDLING MANOEUVRES MUST BE CARRIED OUT BY PERSONAL SPECIALISED AND TRAINED FOR THIS PURPOSE.

Transport can be carried out by air, by sea, or land.

The weight of the stretcher is reported in the technical specifications.

The stretcher can be moved manually.

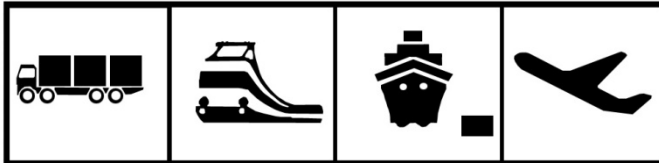

IV.2 PACKING LIST VERIFICATION

Remove the content of the package and check it against the packing list.

If all the components are present and undamaged, the package can be disposed or recycled. If must be

IV.3 FUNCTIONAL TEST

Before using the YDC-8B1 Basket Stretcher:

- Verify if the stretcher whether folded or unfolded according to the present manual;
- If the check result is positive the stretcher is ready for regular use, if it is negative call “RED LEAF” customer service 0512-58516902.

WARNING! The above mentioned check must be repeated at regular intervals in order to verify the efficiency of the product as specified in the section “Maintenance”.

The stretcher is delivered ready for use and require assembling.

Kept in appropriate location, inaccessible to children or animals. If the stretcher has been damaged during shipment, keep the package and call the shipping agent within 48 hours from delivery.

V. OPERATION AND USE

V.1 INSTRUCTIONS FOR USE

- The stretcher YDC-8B1 is exclusively for professional use.
- Use the stretcher only as indicated in this manual.
- Before putting the stretcher in regular



service read the instructions carefully and practice the operating procedures.

- Use the stretcher only when in perfect operating conditions.

V.1.1 STRETCHER JOINING.

Stretcher joining procedure:

- Overturn the two parts of the stretcher;
- (A) Remove the safety split-pin(1);
- (B) Pull out lower joining pin(2);
- (C) Bring the two parts near to each other so that the pins are lined up with their holes.
- (D) Full engage the pins(2) in their holes and fit the lower joining pin;
- (E) Full engage the safety split-pin(1).
- (F) Overturn the stretcher and fit the upper joining pins(3)(4).

WARNING! Full engage the bottom spring pins in their holes during using!

V.1.2 DIVIDING THE STRETCHER

Procedure for dividing the stretcher:

- Remove the upper joining pins(3);
- Pull out connect pins(4);
- Overturn the stretcher;
- Remove the safety split-pin.(1)
- Remove the lower joining pin(2);
- Separate the two parts of the stretcher;

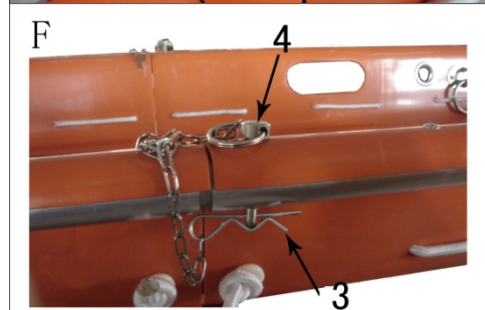
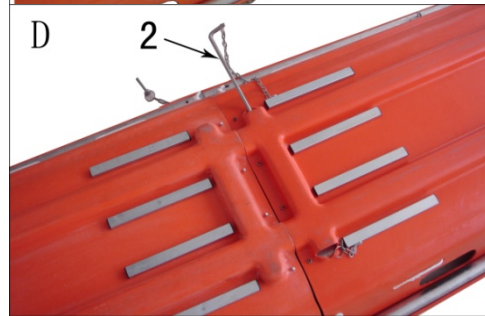
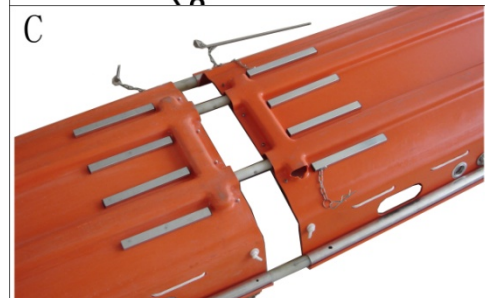
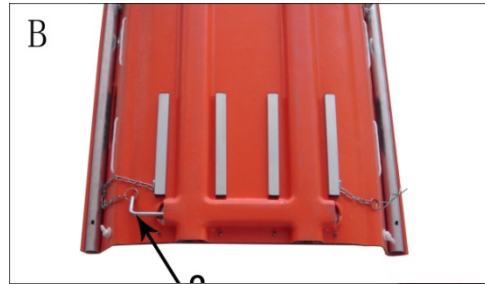

V.2 POSITIONING THE BELTS

WARNING! Check condition of the perimeter



rope and if knots are holding well.

The YDC-8B1 stretcher has four rapidly detaching belts to immobilise the patient during transport.

Belt positions: one belt is used to restrain the chest area, another to restrain the pelvis and the other two to immobilise the legs.

The 4 safety belts must be fixed on stretcher like photo G-H.

V.3 BELT ADJUSTMENT

ALWAYS tell the patient whenever any adjustment is being made.

Rapid detachment procedure: (Photo I)

One side is plastic buckle, another side is iron inset part.

Unfasten the belts as shown in photo sequence I-J-K.

On photo J, pressure red button pull iron inset part outward.

Engage the two parts of the belt until you hear the inset sound(click).

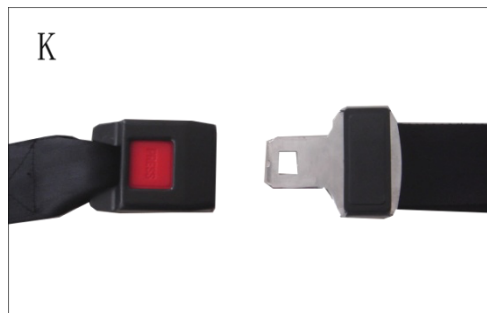

V.4. FEET SECURING BOARD

Attach the feet securing board to the stretcher as shown in photo L.



V.5 LIFTING AND TRANSPORTING

WARNING! The stretcher must be operated by two average height persons in good physical conditions. In particular operators must possess sufficient strength in their back, arms and legs to lift, put and push in addition to good physical balance, reflexes and muscular co-ordination. The movement of the stretcher holding the patient must be carried out with the immobilising belts fastened and the safety devices inseted.

No further specific instructions are necessary for the operations of lifting and transporting the patient on the stretcher.

.6 USING OF HELICOPTER SLING

WARNING! There are 4 units helicopter sling, 2 longer is yellow color used for lower of body, 2 shorter is green color used for upper of body. (Photo M and N).

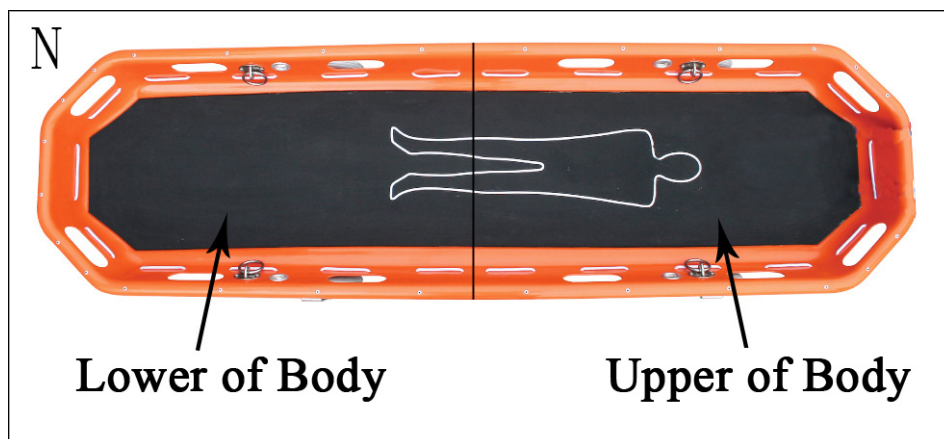
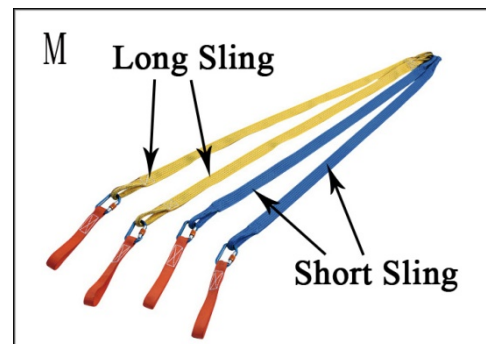

V. 7 OPERATING OF HELICOPTER SLING

Connect lift belt and hook with stretcher



together

before lifting. Photo O, fixed the safety belt through little hole, then (Photo P)revolve the button open(photo Q), and then lock the belt and ring togher by hook (photo R).

WARNING! The movement of the stretcher holding the patient must be carried out with the immobilising belts fastened and the safety devices inserted.

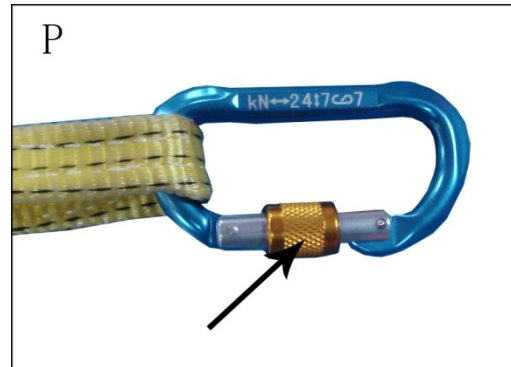

V.8 REQUIREMENTS FOR OPERATORS AND THEIR TRAINING

The operators must:

- Have a practical knowledge of moving patients in emergency;
- Be physically capable of assisting a patient;
- Read this manual and become familiar with the procedures described;
- Be familiar with the YDC-8B1 stretcher before using it in real situations with a real patient;
- Follow a training programme approved by the person in charge of the training of the Medical Emergency Service;
- Have their training verified;
- Do appropriate exercises and be careful to avoid the risk of damaging their spinal cord.

VI. CLEANING AND DISINFECTION

VI.1 CLEANING PRODUCTS

WARNING! Sanitization agents are corrosive.

- Scrupulously observe the instructions provided by the producer of the sanitization agent during use. Whenever possible, consult the producer for guarantees regarding the degree of corrosiveness of the solutions utilised. It is extremely important to follow the specifications regarding the concentration, temperature and reaction times.
- The sanitization intervals to be adopted are defined by the user on the basis of requirements while bearing in mind the information provided in this manual and the instructions listed on the sanitization products employed.

VII. MAINTENANCE

VII.1 ORDINARY MAINTENANCE

Check the basket stretcher after using or more frequently if the product is used in heavy-duty conditions. The inspection must include the search for anything which could compromise the integrity and correct operation of the YDC-8A1, e.g., bent or broken parts. During the inspection it is necessary to carry out the same tests described in “Check before operation”.

WARNING! If there is any sign of damage, put the stretcher out of service until the necessary repairs or replacements have been carried out. Keep a record of the maintenance activities carried out

Every 30 days:

- Clean the rubber parts with water and purger, rinse and dry completely;
- All the removable parts include the hooks;
- Carry out a complete examining

WARNING! IN CASE OF BLOOD-TRANSMITTED DISEASES: To reduce the risk of exposure during use, follow the maintenance instructions contained in this manual and the regulations on personnel safety established by the person in charge of the Medical Emergency Service.

VII.2 STORAGE

Long term storage must be performed according to the following conditions:

The stretcher must be packed;

The storage area must be dry and not exposed to direct sunlight;

Do not stack more than six items.

VII.3 SETTING THE STRETCHER ASIDE

In case the stretcher must be set aside for a long period it is necessary to protect the parts which could be damaged by dust deposits. Grease the parts that could be damaged by oxidation or excessive drying.

VII.4 DISPOSAL

If you decide not to use the stretcher any longer, it is necessary to render it idle. We also recommend to make those parts which can be a source of damage or danger harmless. Evaluate the class of the object according to the disposal degrees.

Dispose together with iron material and send it to the appropriate waste disposal centres. If you consider the stretcher as a special waste, disassemble it and divide it into similar parts, then dispose it according to the legislation in force.

VIII. STRETCHER



IX. STRETCHER PART LIST

NO.	QTY	Code.No.
1	2	8B1001
2	2	8B1002
3	2	8B1003
4	4	8B1004

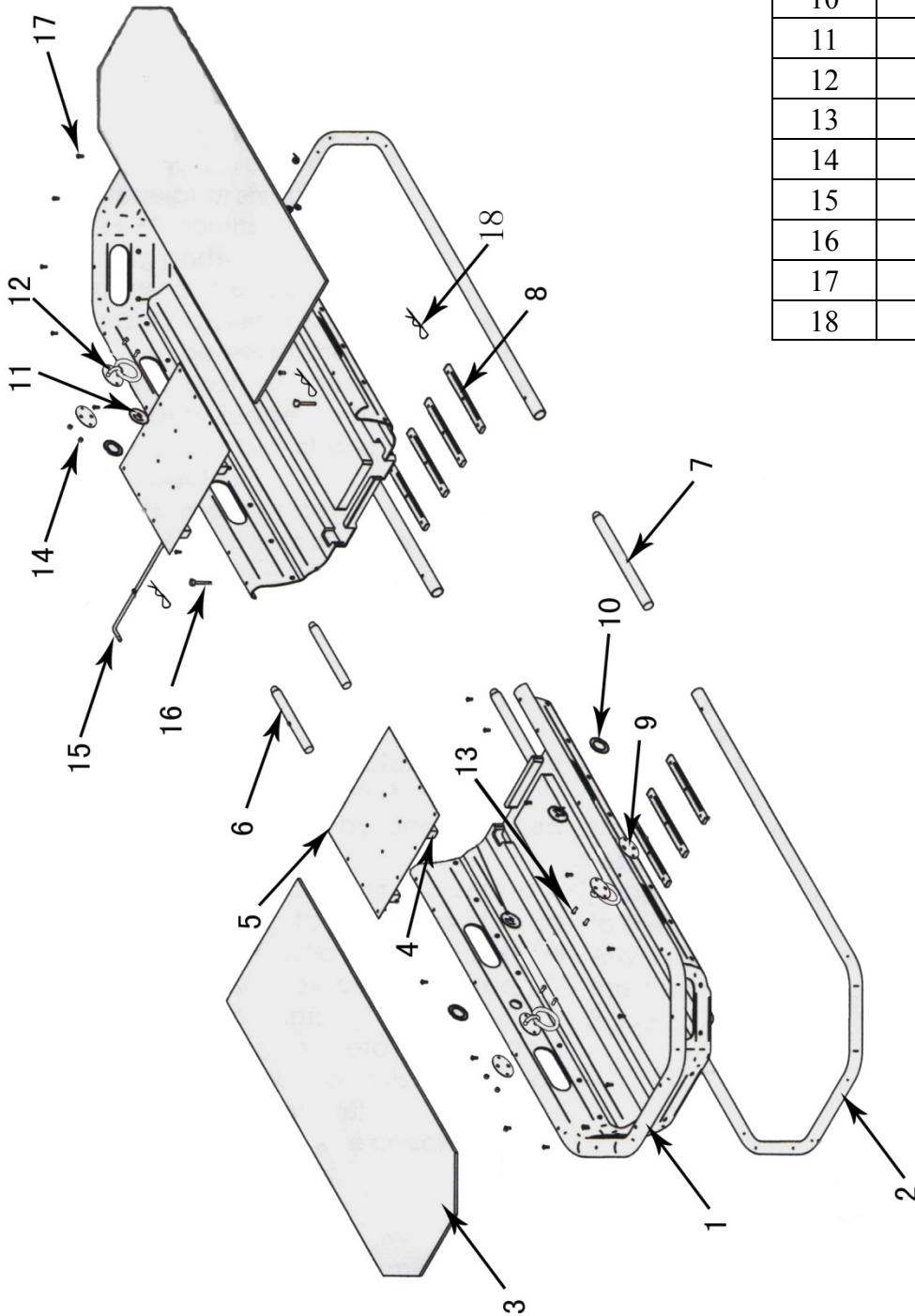

5	2	8B1005
6	2	8B1006
7	2	8B1007
8	8	8B1008
9	2	8B1009
10	1	8B1010
11	4	8A/B015
12	4	8A/B014
13	8	8A/B016
14	8	8A/B013
15	4	8A/B012
16	4	8A/B011
17	26	8A/B017
18	3	8B1011