

HOTTAP

MODEL: JCA11001

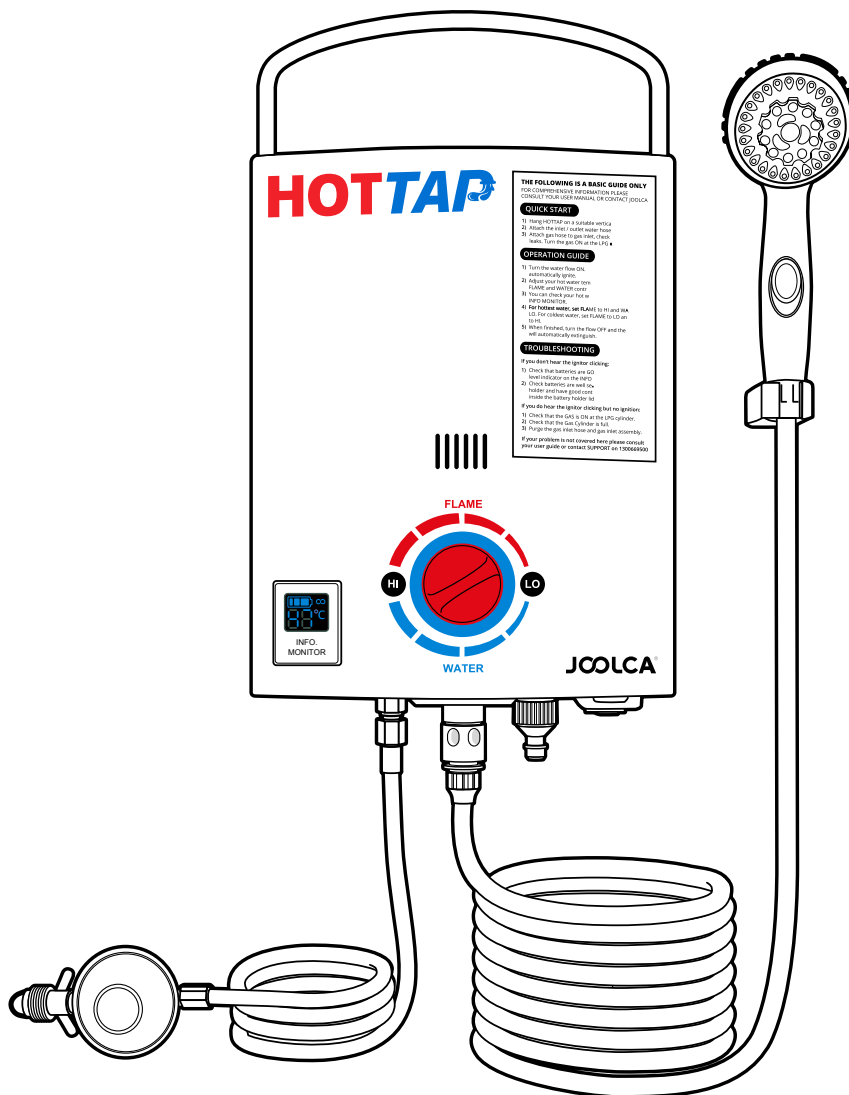

IMPORTANT!

It is important that you read these instructions carefully and understand the operation and safety features of this appliance. Familiarise yourself with the appliance before connecting it to the gas cylinder. Failure to follow the warnings and instructions may result in damage to unit and / or serious injury. Keep these instructions for future reference.



Joolca Well of Wisdom

Check out the Joolca Well of Wisdom. There's a wealth of information on your product including some very handy getting started videos & troubleshooting tips.

Visit <http://support.joolca.com.au> and navigate to your product.



Register Your Joolca 2 Year Guarantee Today

Thank you for choosing to buy a Joolca Product.

Your Joolca product will be covered for parts & labour for 2 years from the date of purchase.

If you purchased directly through us, your items are already registered.

If you purchased through one of our retailers, please register online.

<http://register.joolca.com.au>



CAUTION!

This appliance is not intended for the supply of drinking water.



IMPORTANT!

This appliance is designed to be used with a source water temperature of 20°C or below. If the temperature of the outlet water exceeds 50°C the burners will shut off. You will be required to turn the water flow off and back on to reignite the burners.



WARNING!

This appliance is intended for the supply of heated water for the purpose of washing and cleaning only.



WARNING!

Check and confirm safe water temperature before using this appliance. Water from this appliance may be very hot.



CAUTION!

This appliance must be protected from rain.

SPECIFICATIONS

Dimensions: 370H x 275W x 165Dmm

Weight: 4.3kg

Approval Number: GMK10121

Run Time from 9kg Bottle: ~15hrs

Battery: 2 x D Cell (for ignition only)

Flow Rate: 4L - 6L Per Minute

Max. Temp: 50°C

Min. Water Pressure: 45kPa (low flow), 70kPa (high flow)

Max. Water Pressure: 900kPa

Gas Hose Length: 1.2m

Shower Hose Length: 5m

Nominal Gas Consumption: 28MJ/h

Injector Size: 0.62mm

IN THE BOX

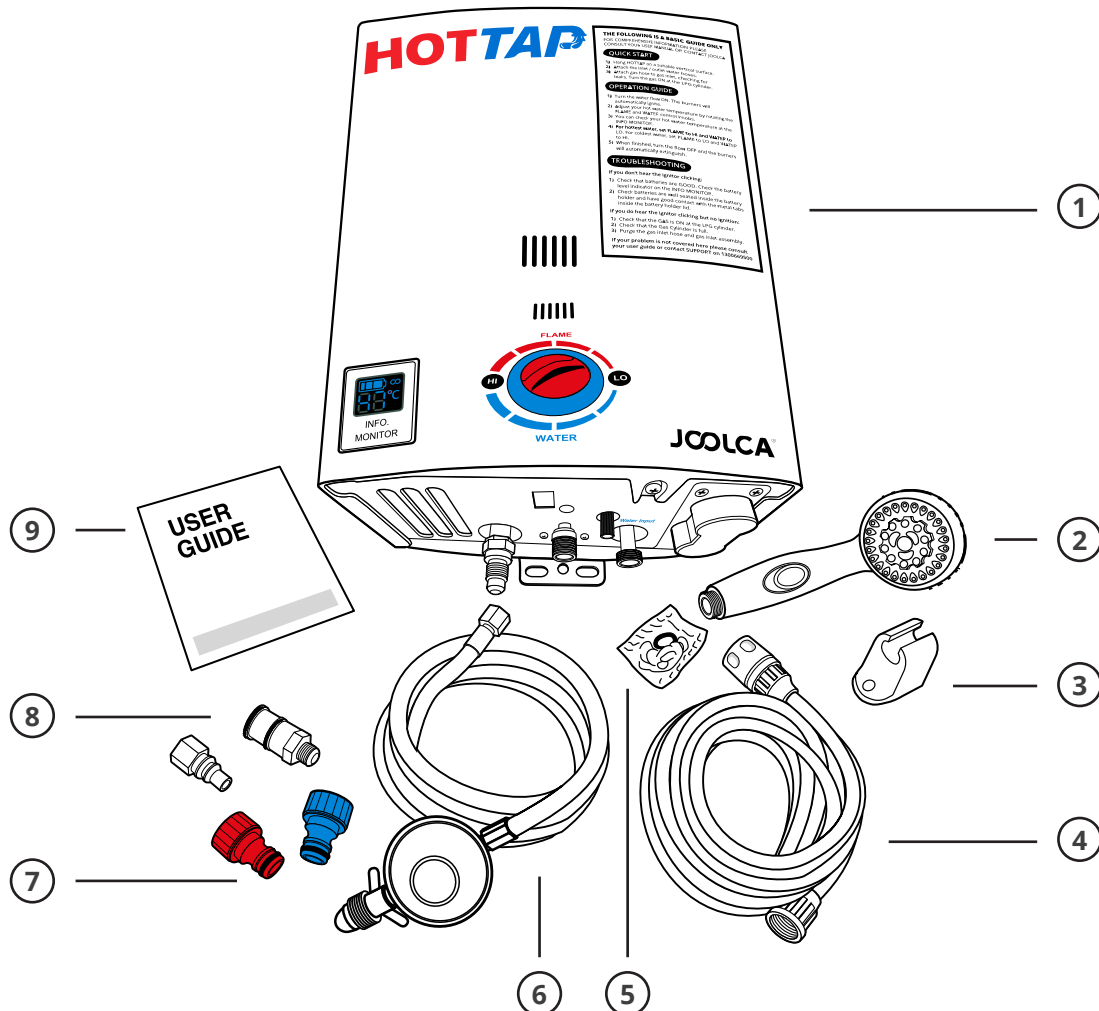

1. HOTTAP Water Heater

2. Shower Head

3. Shower Head Holder

4. 5M Shower Hose

5. Mounting Screws

6. 1.2M Gas Hose

7. Water Inlet & Outlet Adapters

8. GASKNECT Quick Coupler

9. User Guide

GENERAL WARNINGS

This appliance shall only be used with the Australian Approved 1200mm ULPG gas hose and regulator assembly supplied with the appliance and must be connected only to a ULPG gas cylinder certified to AS2469 standards fitted with POL connections only.

IT MAY BE HAZARDOUS TO ATTEMPT TO FIT OTHER TYPES OF GAS CONTAINERS

This appliance is to be stored in a dry and well-ventilated location free from direct sunlight. Do not store when still connected to the cylinder. Make sure that the cylinder is disconnected and is stored in a well-ventilated area, free from direct sunlight, heat and ignition sources and out of reach of children. If being stored indoors, ensure that the location complies with the standard AS/NZS1596.

This appliance must only be serviced by an authorized service agent, return to your place of purchase for service and repair.

DANGER!

- This appliance is designed for outdoor use only.
- Use only in well ventilated areas.
- Do not use this appliance if it has damaged or worn seals.
- Do not use this appliance if it is leaking, damaged, or does not operate properly.
- CAUTION: Accessible parts may be very hot. Keep young children away.

• USE OUTDOORS ONLY

- This appliance shall only be used in an above ground open-air situation with natural ventilation, without stagnant areas, where gas leakage and products of combustion are rapidly dispersed by wind and natural convection.
- Do not use adaptors or modify the appliance to fit

other connectors or cylinders.

- When using this appliance, children must be supervised by an adult at all times.
- Never leave the appliance unattended when operating.
- Do not use as cooking appliance or modify for any other reason.

CARBON MONOXIDE HAZARD

ONLY USE IN WELL-VENTILATED AREAS.

CARBON MONOXIDE HAZARD - USING THIS APPLIANCE IN AN ENCLOSED SPACE MAY CAUSE DEATH. DO NOT USE IN CARAVANS, TENTS, MARINE CRAFT, CARS, MOBILE HOMES OR SIMILAR LOCATIONS.

IMPORTANT

- Avoid twisting and kinking the ULPG Gas hose.
- If there is a leak on your appliance (smell of gas), immediately attempt to turn off the cylinder valve. Remove the appliance to a well-ventilated location away from any ignition source. Check for leaks using soapy water. Do not try to detect leaks using a flame.
- Do not attempt to move or relocate the appliance when it is operating.
- Extinguish the burner and allow to cool. Disengage the gas cylinder then move the appliance.

CHECK FOR GAS LEAKS

- Check that seals between the appliance and the gas container are in place and in good condition before connecting the gas container.
- Only use the hose assembly as supplied with this appliance for connection to the cylinder – **DO NOT USE ADAPTORS.**

- Check that all connections are tight and that the gas cylinder connection has been tightened before you turn the cylinder gas valve on.
- **NEVER CHECK FOR LEAKS WITH A FLAME OR PILOT LIGHT.**
- Using soapy water, coat all connections. If bubbles appear turn the cylinder gas control off and retighten the connection before re-testing.
- Inspect the appliance regularly for signs of wear, leaks or incorrect operation. If symptoms such as flaring of the burners, issues with lighting, damage to hoses or connections or leaks from seals or gas controls are identified do not attempt to repair, contact Joolca Customer Care on 1300 669 500.
- To check if gas remains in the cylinder, disconnect from the appliance and hold the cylinder in a vertical position then shake from side to side, if there is a sound or feel of liquid movement inside the cylinder contains gas.
- When changing gas cylinders ensure this is conducted outside in a well-ventilated location free from people, animals and ignition sources such as naked flames, pilot lights and electrical equipment such as heaters or elements.

SAFETY INSTRUCTIONS

This appliance must only be used in an above ground open-air situation with natural ventilation, without stagnant areas, where gas leakage is rapidly dispersed by wind and natural convection.

The following figures are diagrammatical representations of outdoor areas suitable for use with this appliance. Rectangular areas have been used in these figures – the same principles apply to any other shaped areas.

ANY ENCLOSURE IN WHICH THE APPLIANCE IS USED SHALL COMPLY WITH ONE OF THE FOLLOWING:

A) AN ENCLOSURE WITH WALLS ON ALL SIDES, BUT NO OVERHEAD COVER:

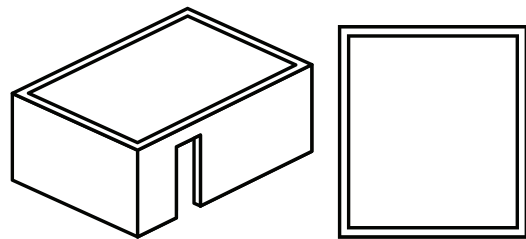

FIGURE A1 – Outdoor Area Example 1.

B) WITHIN A PARTIAL ENCLOSURE THAT INCLUDES AN OVERHEAD COVER AND NO MORE THAN TWO WALLS:

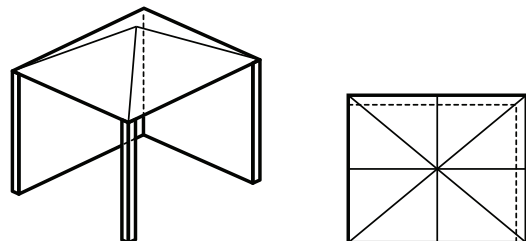

FIGURE B1 – Outdoor Area Example 2.

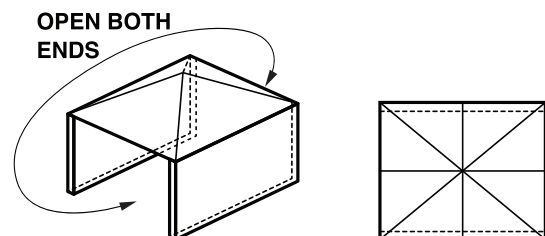

FIGURE B2 – Outdoor Area Example 3.
With both ends open.

C) WITHIN A PARTIAL ENCLOSURE THAT INCLUDES AN OVERHEAD COVER AND MORE THAN TWO WALLS, THE FOLLOWING SHALL APPLY:

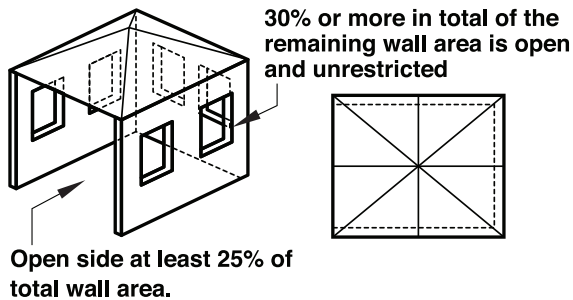

FIGURE C1 – Outdoor Area Example 4. With the open side at least 25% of the total wall area and 30% or more in total of remaining wall area is open and unrestricted.

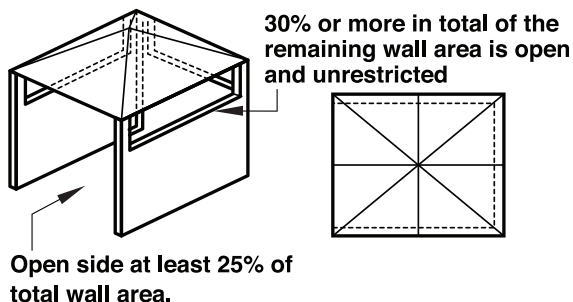

FIGURE C2 – Outdoor Area Example 5. With the open side at least 25% of the total wall area and 30% or more in total of the remaining wall area is open and unrestricted.

SAFETY FEATURES

This appliance is equipped with the following safety features:

Over temperature sensor – The appliance will not allow the burner to remain in operation once the outlet water temperature reaches 50°C. To relight the burner you will need to turn the water flow off and back on.

Water flow sensor – Water must be flowing through the system to allow the burner to ignite. In the case that the water supply is restricted or ceases, for example if you close the water flow at the shower nozzle, the burner will be extinguished and will not relight until the water flow recommences.

HANGING THE APLIANCE

Outdoor use only - The appliance must be used outdoors only and is to be operated no closer than 500mm from the sides and 1000mm from above to all combustible surfaces, fabrics, flammable materials and people.

The appliance is designed to be hung upright against a non-combustible vertical surface. Do not operate from a non-upright position doing so can be dangerous and will damage the appliance.

During operation ensure that both air inlets and the top exhaust are kept free from obstructions and closure.

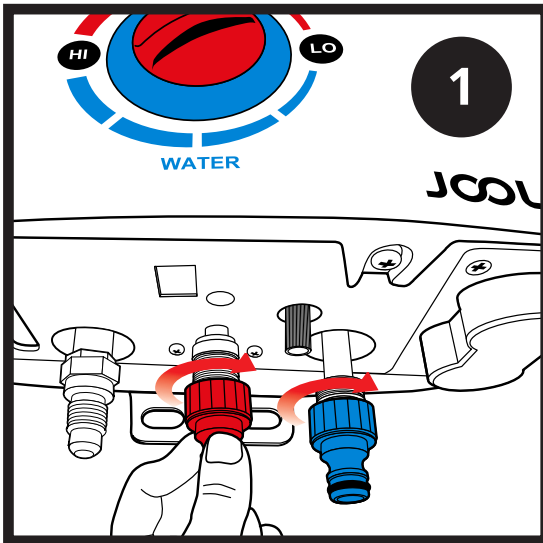

1. Connect the 'blue' and 'red' Joolca quick connect fittings to the 'Water Input' and 'Water Output' threads respectively.

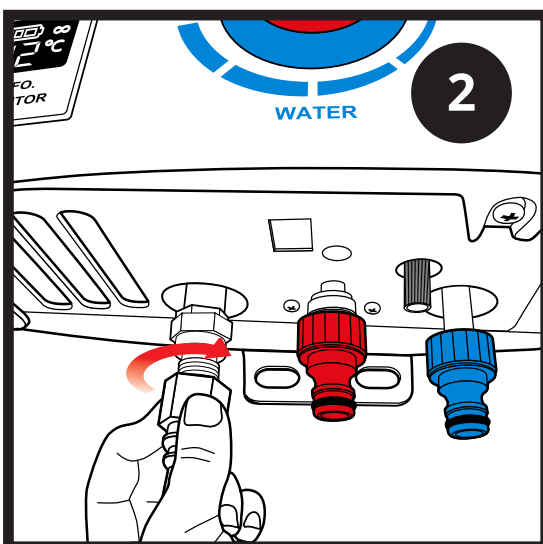

2. Connect the male side of the GASKNECT quick coupler to the gas inlet of the appliance. Apply Teflon tape to avoid leaks.

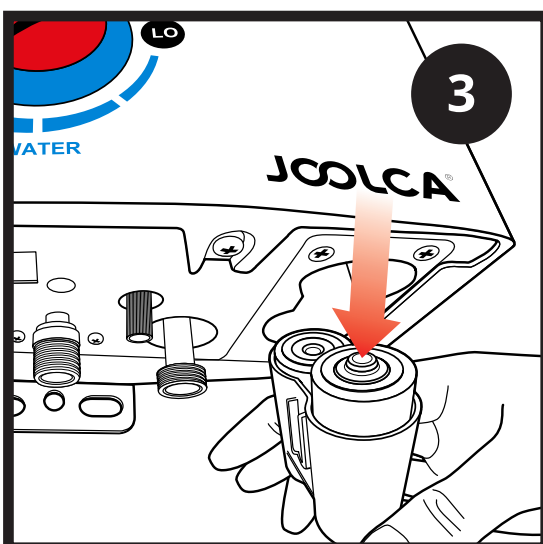

3. Observing the correct polarity, install 2 D-cell batteries into the battery box.

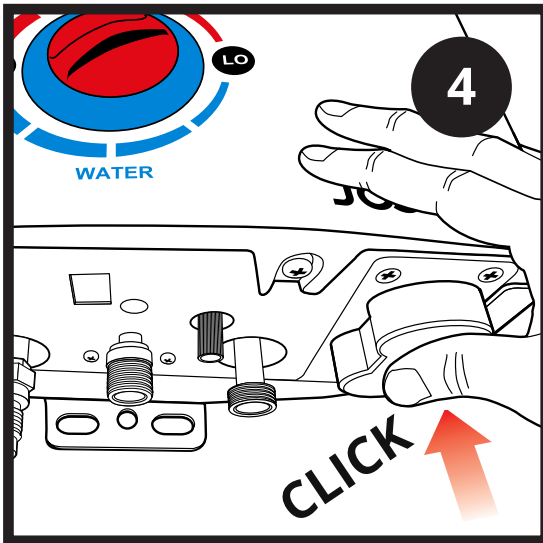

4. Press in to close the compartment.

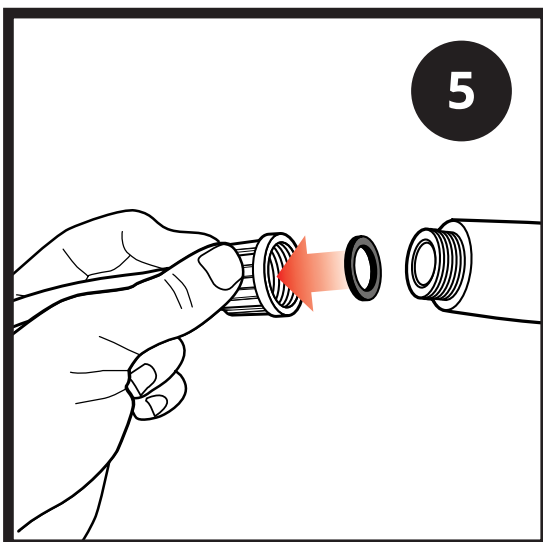

5. To connect the showerhead to the shower hose, place one of the washers (contained in the pack) between the threaded connection of the shower hose and the shower head.

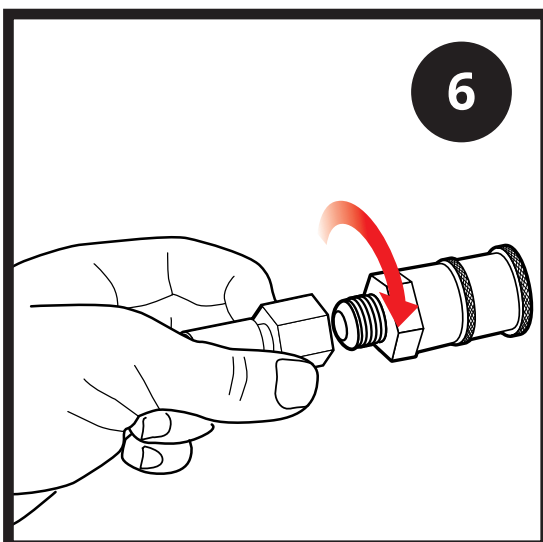

6. Attach the female side of the GASKNECT quick coupler to the end of your gas hose. Apply Teflon tape to avoid leaks.

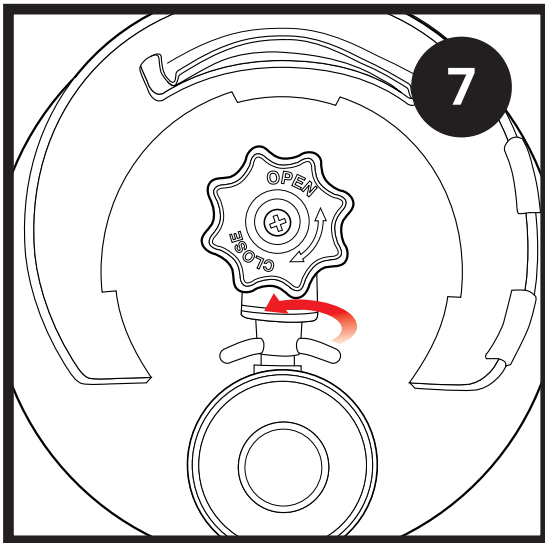

7. Connect the gas regulator to the POL ULPG gas cylinder. Hand-tighten the connection in an anti-clockwise direction. Ensure gas is in the 'OFF' position.



NOTE

HOTTAP can be used with a water input source that provides at least 45kPa (on low flow) of pressure. This guide will use a mains pressure (i.e. garden tap) as the water input source.

FOR USE WITH WATER INPUT SOURCES, SUCH AS THE FLOTAP LOW VOLTAGE PUMP, PLEASE CONSULT THE PUMP INSTRUCTION MANUAL OR CALL JCOLCA CUSTOMER CARE ON 1300 669 500.

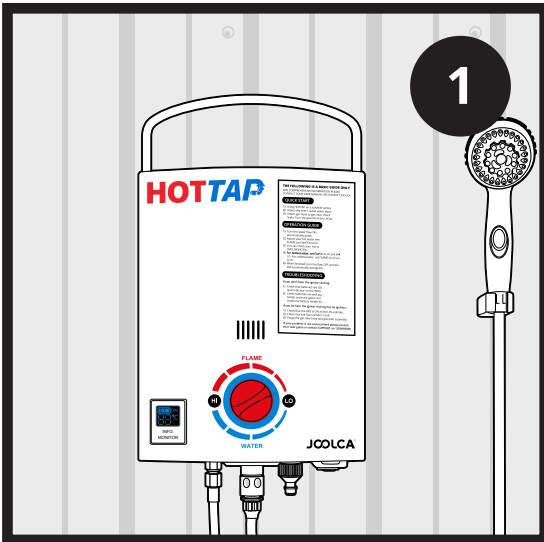

1. Find a suitable, sturdy, non-combustible vertical surface to hang the appliance on via the carry handle. The surface should be at least 500mm clear from the sides and 1000mm from the top of all combustible surfaces, fabrics, flammable materials and people.

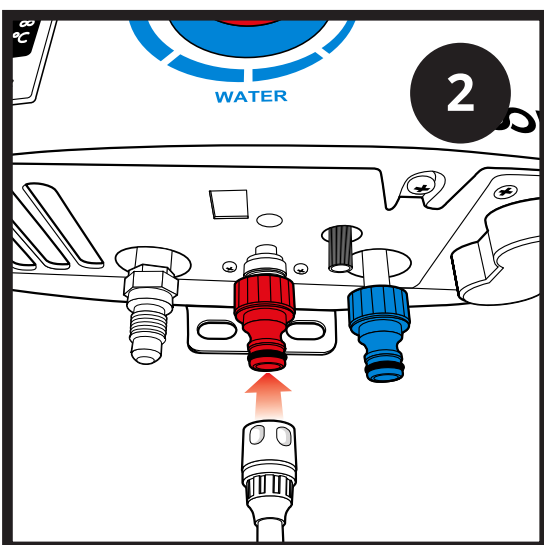

2. Attach the shower hose to the 'red' quick connect fitting (water output).

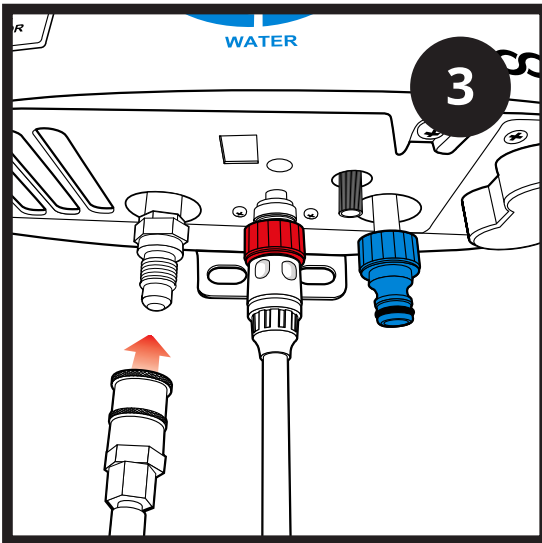

3. Quick Connect the flexible gas hose to the 'gas inlet'.

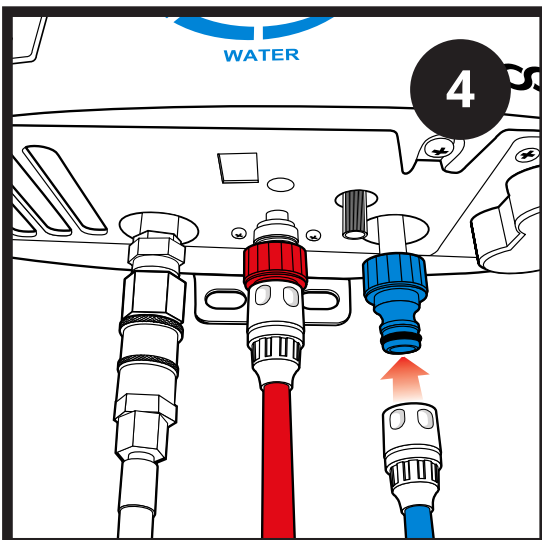

4. Attach your water inlet hose to the 'blue' quick connect fitting (water input).

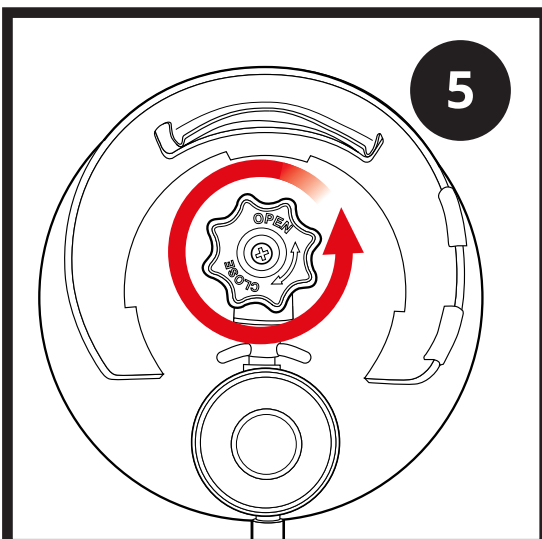

5. Turn the gas cylinder on, 'Open', in an anticlockwise direction one full turn. Check the connection for leaks by coating orifices with soapy water. DO NOT use a flame. If bubbles occur or a leak is detected, turn the cylinder valve off, 'Close', retighten all connections and retest.

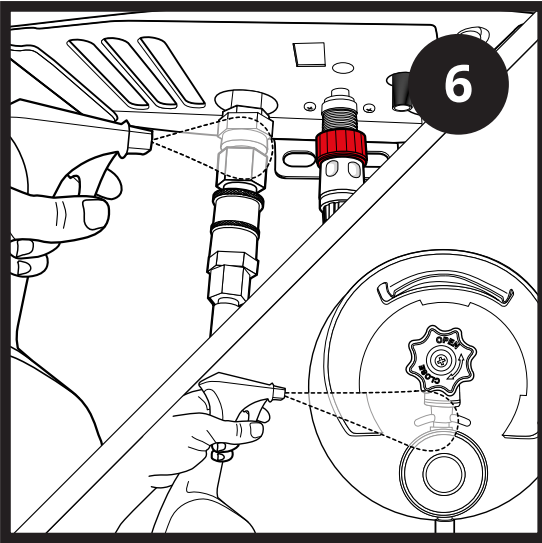

6. Once it has been determined that there are no leaks present, the appliance is ready to use. Turn the gas cylinder off.



NOTE

The gas cylinder must be positioned away and to the side of the appliance. It must never be directly aside, below or above the appliance.

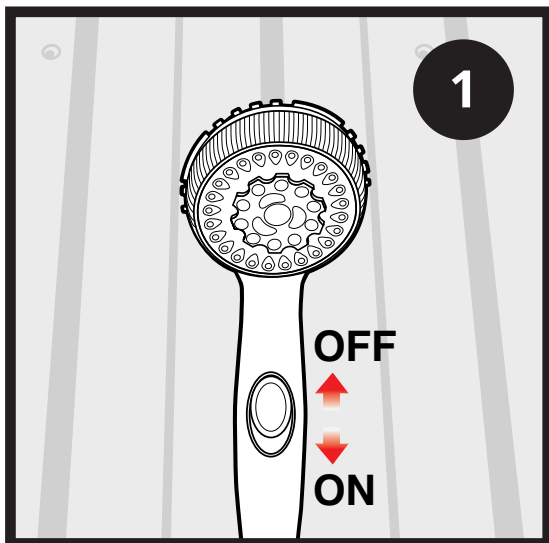

1. Ensure the flow regulation switch on the shower nozzle handle is in the 'Off' position.



IMPORTANT!

It is important that when starting the appliance that the **gas** regulator is set to the '**minimum**' position (i.e. turned clockwise completely to the right).

It is important that when starting the appliance that the **water** regulator is set to the '**maximum**' position (i.e. turned clockwise completely to the left).

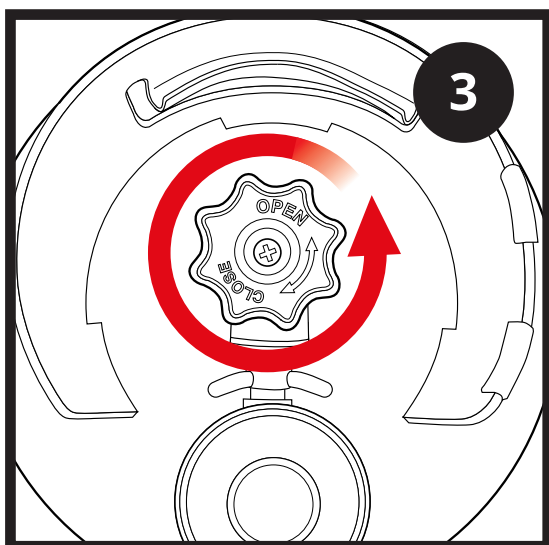

3. Turn the gas cylinder on, 'Open', in an anticlockwise direction one full turn.

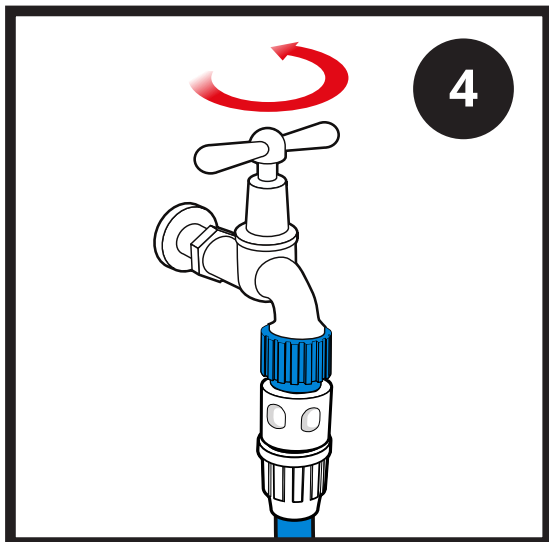

4. Open the valve for the input water source.



NOTE

Water should not flow out as the shower nozzle is in the 'Off' position.

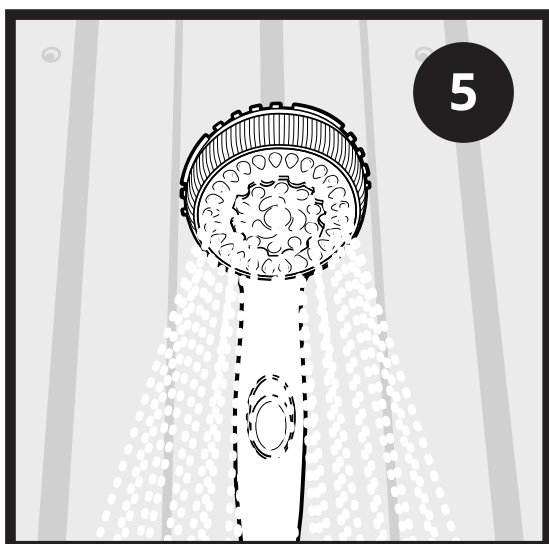

5. When ready, slide the flow regulation switch on the shower nozzle to the 'On' position. Water will start to flow.

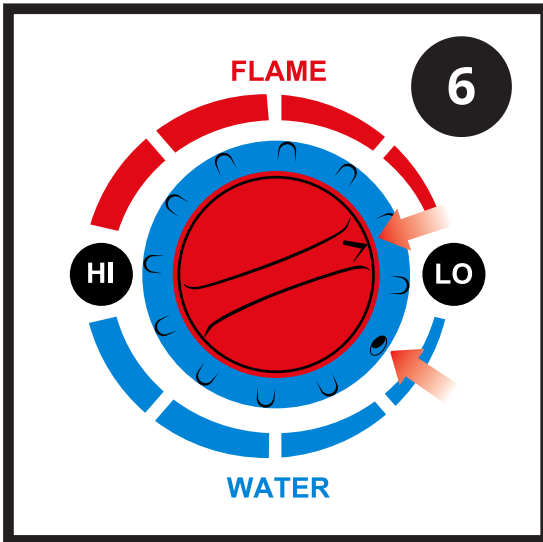

6. Adjust the 'Flame' and / or 'Water' Flow knobs to reach your desired temperature and flow rate.

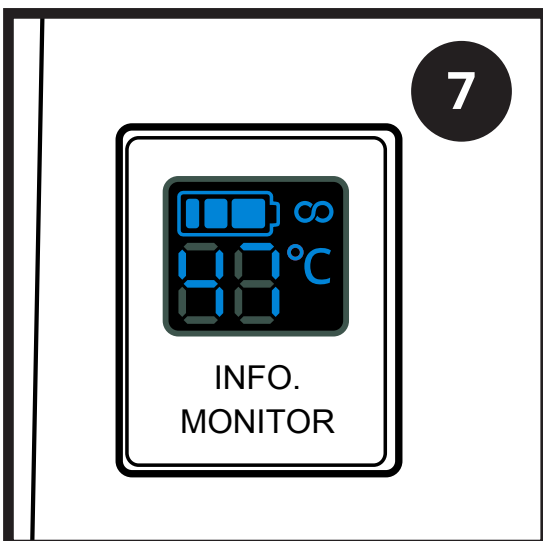

7. Take care to test the temperature of the water flowing from the shower head as it may be hot enough to cause injury.



NOTE

For higher temperatures increase the 'Flame' regulator control and decrease the 'Water Flow' regulator control.

The water flow can be stopped at any time by sliding the regulation switch on the shower head to the 'Off' position. The burner will extinguish.

To reignite the burner, slide the flow regulation switch on the shower head to the 'On' position. Water flow will commence and the burner will automatically ignite.



With the appliance operating, turn the gas cylinder off, 'Close'. The burner will continue to operate until all gas has been bled from the gas hose and regulator assembly.

1. Turn off the water supply at the tap (mains) and disconnect from the 'Water Input'. Disconnect the shower hose from the 'Water Output'. Allow all water to drain out from hosing before rolling up and storing away.
2. Disconnect the gas regulator and hose assembly from the appliance and store away. To do this;
 - 2.1 First, check that the appliance is fully extinguished; the gas cylinder control valve is in the fully off, 'Close', position and all surfaces are cool.
 - 2.2 Disconnect the gas hose from the appliance by pulling down on the female side of the GASKNECT quick coupler.
3. Disconnect the quick connect adaptors from the 'Water Input' and 'Water Output'.



Using warm, soapy water and a mild detergent wipe down all surfaces and areas of the appliance. Take care not to allow water to enter the top vent. Before each use, check that the screen filter on the 'Water Input' pipe is in place and cleaned of any particles.

DO NOT Submerge the appliance in a sink or bowl.

DO NOT Use abrasive cleaners or bleach.



Joolca Well of Wisdom

Check out the Joolca Well of Wisdom. There's a wealth of information on your product including some very handy getting started videos & troubleshooting tips.

Visit <http://support.joolca.com.au> and navigate to your product.

This guide should be followed in case of failure of the appliance to operate correctly. If symptoms persist contact Joolca Customer Care on **1300 669 500**.



IMPORTANT!

Do not attempt to repair or modify the appliance.

THE APPLIANCE WILL NOT IGNITE AT ALL

Ensure new batteries are installed in the correct polarity (+/-). Check the cap of the battery case for instructions on how they should be installed. Check that batteries are not past their expiration date.

Check for sufficient water flow and pressure. The unit must have a minimum of 45kPa of sustained water pressure and at least 4LPM to activate the burners. At high water flow, 70kPa is required.

There is the possibility of finding some kind of epoxy or debris within the water regulator. Check that the water inlet filter screen is clean. To flush the system, connect the input water source to the 'Water Outlet' and turn on. Once complete, reconnect the appliance as per instructions.

If you can hear 'clicking', but no ignition, the batteries could be running low. This can also be heard as the clicking slows down to approx. 1-2 clicks per second, rather than approx. 4-5 tickers per second when full. Try a fresh set up batteries and check the expiration date to ensure they are not expired.

THE UNIT STARTS FOR A SHORT AMOUNT OF TIME AND THEN SHUTS OFF

Check for sufficient water flow and pressure. The unit must have a minimum of 45kPa (at low water flow) of sustained water pressure and at least 4LPM to activate the burners.

Do not expose the water heater to strong winds as this may cause the flame to blow out.

If the unit starts on low water flow setting but turns off when you adjust the water flow setting higher; you either don't have enough water pressure to operate the unit at this higher flow rate (perhaps using gravity feed or an undersized pump) or you have a blockage in your lines / water inlet. Check for debris in the water inlet mesh filter (inside the brass threaded inlet fitting) on the HOTTAP.

WATER IS NOT HOT ENOUGH

Adjust the gas regulator and water regulator to meet your desired temperature. To increase temperature; turn the gas regulator control from minimum to maximum and turn the water regulator control from maximum to minimum.

Check source water temperature. If the source water temperature is too cold then you may need to 'cycle' the water through the system back into the source reservoir then through the appliance again to meet your desired temperature.

Check if there is a blue flame in the 'viewing window'. If you see a yellow flame it could mean a breakdown in the gas regulator - immediately shut down the unit. Please call Joolca Customer Service directly if this happens, **DO NOT** attempt to use the appliance.



Your Joolca appliance will be covered for parts and labour for 2 years from the date of purchase, as detailed in the terms of the Joolca guarantee on the Joolca Website: <http://support.joolca.com.au/warranty>

If you have a query about your Joolca appliance, call the Joolca Customer Care quoting your serial number and details of where and when you purchased the appliance (If applicable). Alternatively, contact us via the website.

Most queries are answered on our support portal by visiting <http://support.joolca.com.au> or alternatively over the phone by one of our Joolca Customer Care Helpline staff.

Website: <http://.joolca.com.au>

Email: support@joolca.com.au

Joolca Customer Care: 1300 669 500

Address: Joolca Head Office – Australia, 27A Production Drive, Campbellfield, VIC, 3061