

# **Lindsell Hoists** <sup>TM</sup>

[www.lindsellhoists.com.au](http://www.lindsellhoists.com.au)

Locked Bag 1  
Point Leo  
Victoria 3916

ABN 15 007 308 830

[lindsellhoists@bigpond.com](mailto:lindsellhoists@bigpond.com)

**Lindsell Hoists Freecall 1800 815 360**

This Hoist complies with and/or exceeds the requirements of the AS1418 Crane Code.

## **Lindsell Hoist Operating & Safety Procedure**

### ALL Models

1. Secure your load with correct sling or chain (fastening device).
2. Ensure vehicle is stabilised and ground surface safe. Check if not too soft.
3. Lift slowly and check visually for incorrect centre of gravity. ie. Will the load tip out of sling?
4. Use push button control to move load in desired direction. Know the control settings.
5. Stand clear of load.

Please call Freecall 1800 815 360 should you require any further assistance in operating a Lindsell Hoist.

**Lindsell Hoists Freecall 1800 815 360**

**YOUR LINDSELL HOIST IS BUILT TO GIVE YOU MANY HOURS OF DEPENDABLE USE. BEFORE PUTTING YOUR HOIST TO USE. WE URGE YOU TO READ THE FOLLOWING OPERATING INSTRUCTIONS AND SAFETY PRECAUTIONS.**

## **SAFETY PRECAUTIONS:**

1. Study the operating instructions and safety precautions carefully before use.
2. Know the controls and how to stop the motor quickly.
3. Give your best attention to the lifting and lowering job before commencing to lift or lower. Make sure bystanders have cleared the surroundings before commencing.
4. Always keep your hands and feet clear of moving parts and the path of the items being lifted or lowered.
5. Wear sturdy rough sole work shoes, preferably with a steel toe cap and close fitting slacks and shorts to avoid entanglement in moving parts.
6. Before using, always visually inspect the Hoist, replace any worn or defective parts before use. Check all nuts, bolts, screws and other fasteners regularly - always be sure the hoist is in a safe condition before use. Always inspect cables before use. Always avoid kinking of cables. Lubricate all parts as necessary.
7. Check overhead clearance carefully before operating under power lines, guy wires, bridges or low hanging tree branches, before entering or leaving buildings or in any other situation where operation may be impeded which could result in serious injury.
8. To maintain control of the Hoist, operate smoothly and avoid erratic operation and excessive speed.

Lindsell Hoists Freecall 1800 815 360

## SAFETY PRECAUTIONS (contd.)

9. Disengage power and stop the motor before making repairs or adjustments.
10. Always stop the motor before checking cable and tension.
11. Do not change motor governor setting or overspeed the motor.
12. Use the Hoist only in good daylight or good artificial light.
13. Do not operate the Hoist when fatigued - fatigue causes carelessness.
14. Do not allow children or people unfamiliar with the Hoist or its operation to use the hoist.
15. Take all possible precautions when leaving the Hoist unattended. Always prevent tampering with the Hoist by unauthorised persons.

## CHECK LIST

|                                     |           |
|-------------------------------------|-----------|
| TRAY IS REINFORCED                  | CHECK [ ] |
| ALL PINS AND SAFETY CLIPS INSTALLED | CHECK [ ] |
| HYDRAULIC FITTINGS ARE TIGHTENED    | CHECK [ ] |
| POWER CABLE IS NOT RESTRICTED       | CHECK [ ] |
| HYDRAULIC LINE IS NOT RESTRICTED    | CHECK [ ] |
| POWER PACK BRACKET IS SECURE        | CHECK [ ] |
| BOOM IS NOT RESTRICTED              | CHECK [ ] |
| HYDRAULIC TANK IS FILLED            | CHECK [ ] |
| HOIST IS GREASED                    | CHECK [ ] |

**THIS PROCEDURE SHOULD BE CARRIED OUT WHENEVER YOU OPERATE YOUR LINDSELL HOIST.**

## Lindsell Hoist ALL Models

### OPERATING INSTRUCTIONS

#### Operating Flow Control Valve

1. See drawing below. This shows details of what the valve looks like and where it is located.
2. This valve allows the lift booms lifting and lowering pace to be adjusted. The valve is a two way unit, meaning it restricts the flow of oil both on the up and down movement.
3. To test the valve's ability, open the valve by rotating the black knob in an anticlockwise direction to open and allow full flow of oil. Using the handset control press the Up button and determine if the pace is too fast in lift. Note that the heavier the load the slower the boom will lift.
4. When lowering with valve fully open and maximum load, the unit may be too fast lowering. Hence turn the black knob in a clockwise direction and restrict the oil flow to determine a safe pace.
5. What is a safe pace? A safe pace is where operator reaction is quicker than the lowering or lifting speed of the boom should a sudden stop be required.

Lindsell Hoists Freecall 1800 815 360

## ASSEMBLY DIAGRAM "FLOW CONTROL TAP"

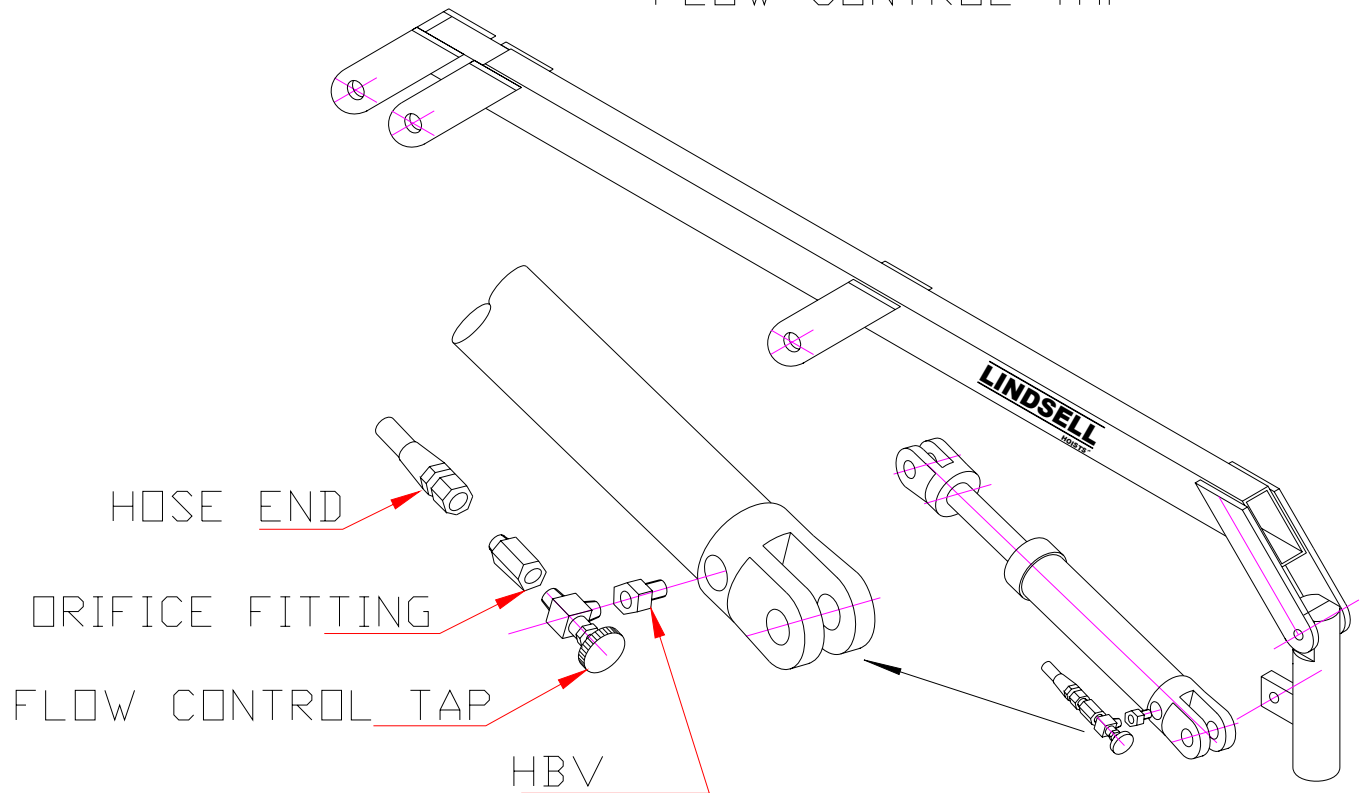

Lindsell Hoists Freecall 1800 815 360

## Handset Controls

The handset buttons are as stated on the face of the buttons.

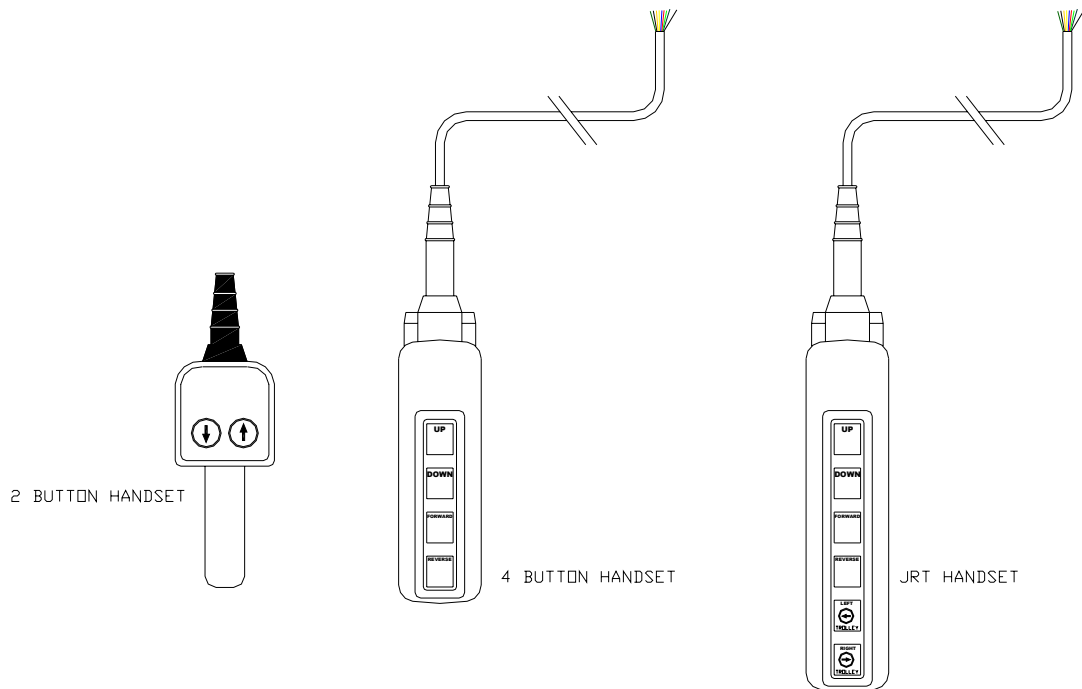

### 1. Up and Down (ALL MODELS)

To activate the lift or lowering of the boom, press the button on the handset. Select the button

ie. Marked “Up” or:



Marked “Down” or:



### 2. Forward and Reverse (Option)

This refers to the hydraulic cylinder on top of the boom, which hydraulically extends and retracts.

Lindsell Hoists Freecall 1800 815 360

Buttons are marked “Forward” or “Extend” to extend.

Buttons are marked “Reverse” or “Retract” to retract.

### 3. Slew Left and Right (Option)

This refers to the Hydraulic Motor on the Gearbox at the base of the Hoist centre column.

Marked “ Left Slew” or

Marked “Right Slew” or

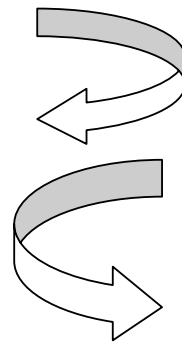

### 4. Radio Remote

To turn on the Radio Remote Module, Press the “On” button for at least 5-10 seconds. The unit should now be ready for operation.

To turn off the unit, press the “Off” button for at least 5-10 seconds.

The unit will turn off automatically after approx. 5 minutes.

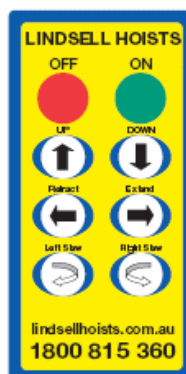

Lindsell Hoists Freecall 1800 815 360

## The Support Leg

This is underneath the base of the Lindsell Hoist and allows the vehicle to stabilise and prevent the tray from leaning or tipping over. Ensure it is used on stable ground and adjusted to suit height of tray. Always lift and lower with the tray level.

## General Advice

Check the W.W.L label to ensure lift capacity of crane

An example is a 1 x 205 litre (44 gallons ) is approxiamte 205 kgs . Know your items weights .This indicates that the operator should be competent and know how to sling and secure the load correctly. It is recommend that training in Lifting Slings and Hooks be obtained.

Lift small loads ie. 50 kg to get used to the controls and trial in positioning drop off and pick up zones.

Preparation is the key to the successful use of your Lindsell Hoist.

If in doubt, stop! Assess the lift before using your Lindsell Hoist.

Ring Freecall 1800 815360 and ask for operating assistance or any technical advice.

This service is available 24 hours, 7 days a week.



Lindsell Hoists Freecall 1800 815 360

## Hooks and Lifting Slings

This procedure requires constant observation on the operator's behalf; it is strongly recommend that all operators are aware of the manufacturers safety standards

### Hooks

Supplied is a 1.5 Tonne Universal Hook. ASA 3777 –1990

Note: the Lindsell Hoist has a restricted pressure setting so that the unit will not exceed 750 kg lift. If the hook(s) have lifted in excess of 1.5 tonne loads then it should be replaced.

### Lifting Slings

Supplied units are Tested and Certified slings.

Check each sling's labels and follow manufacturers advice.

### HOW TO ORDER REPLACEMENT PART

1. Identify part by serial number or visual copy from this manual.
2. Call Freecall 1800 815 360 or Fax 03 5889 8811

# Troubleshooting Procedure for Lindsell Hoist

## Symptom

- Pulsing
- No Movement
- Staggering, Clicking Sound but no movement
- Sluggish lift
- Part Movement on some functions

## Action

1. Check Battery Connections and Output on Vehicle. If you start engine does the unit then work.
2. Check 9V DC Alkaline Battery in handset
3. Check for loose wires around valves
4. Try using manual overrides ( See Attached )
5. Check 7 or 12 pin connections in radio remote line

## Further Checking

1. Swap solenoid to check circuit. You will need electrical drawing to ensure you understand colour circuit.
2. Using two small pieces of insulated 3mm wire you can electrically override system. Using “**only**” the female 7 or 12 pin plug connect. Every unit is matched and if you look at circuit drawings all units are

- a. **Red + Brown + Green**.....Crane boom goes **UP**
- b. **Red + Black** .....Crane boom comes **DOWN**
- c. **Red + Brown + Yellow** .....Crane boom **EXTENDS**
- d. **Red + Brown + Blue**.....Crane boom **RETRACTS**
- e. **Red + Brown + Pink**.....Crane boom **SLEW LEFT**
- f. **Red + Brown + WHITE**.....Crane boom **SLEW RIGHT**

3. Call Freecall 1800 815360 for service assistance.

4. L-12RLP models only.

**Red + Yellow**...hoist goes **Up**

**Red + White**...hoist goes **Down**

**Operating Competency Test - All Models**

**Operator Name:**

**Date Tested:**

**Examiner:**

|  | <b>Passed</b> | <b>Fail</b> |
|--|---------------|-------------|
| • <b>Read and understands Safety Procedure</b>       | -----         | -----       |
| • <b>Understands Safety Precautions</b>              | -----         | -----       |
| • <b>Understands Flow Valve Function</b>             | -----         | -----       |
| • <b>Understands Hand Control / Remote Operation</b> | -----         | -----       |
| • <b>Understands Support leg Operation</b>           | -----         | -----       |
| • <b>Read and understands General Advice page 8</b>  | -----         | -----       |
| • <b>Understands Sling and Hook Advice</b>           | -----         | -----       |
| • <b>Understand Troubleshooting Procedures</b>       | -----         | -----       |

**The above Operator Test is applied to all Lindsell Hoists. Any person(s) that have completed the above and passed all points are considered competent and compliant to operate a Lindsell Hoist.**

**The above test applies to the document titled “Lindsell Hoists Operating and Safety Procedure”. For a copy of this document contact Lindsell Hoists TM**

**Disclaimer**

**Lindsell Hoists endeavour to provide best practice in operating our cranes and tipplers to our clients. Our company will not be held responsible for injury and or death caused by unsafe work practices whilst using a Lindsell Hoist.**

Lindsell Hoist - Model Knuckle Boom  
Coates Hire Special KNRLP3  
Maximum Lift 250 KG Full Extension

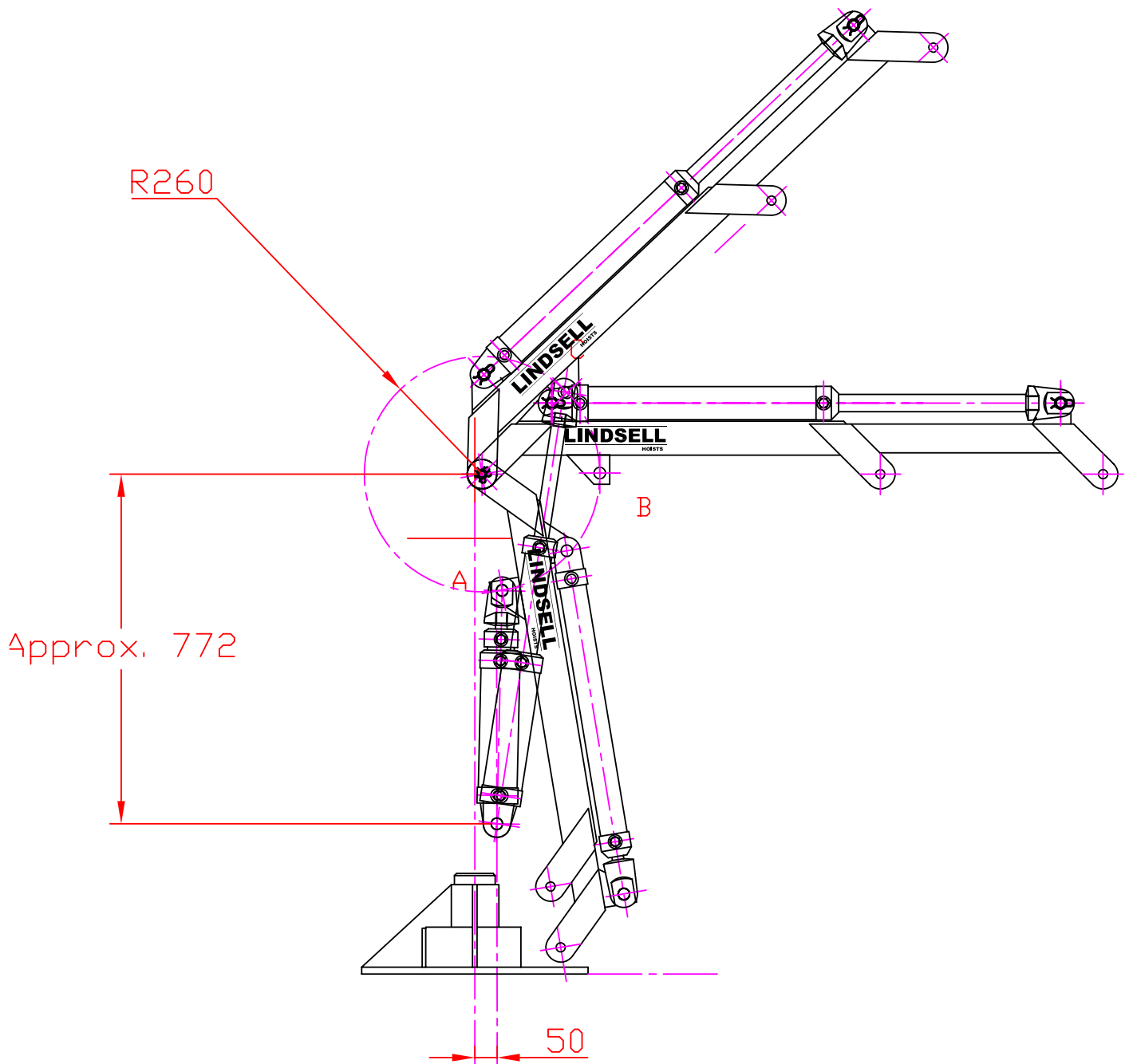

# Lindsell Hoists <sup>TM</sup>

[www.lindsellhoists.com.au](http://www.lindsellhoists.com.au)

Locked Bag 1  
Point Leo  
Victoria 3916

ABN 15 007 308 830

[lindsellhoists@bigpond.com](mailto:lindsellhoists@bigpond.com)

**Lindsell Hoists Freecall 1800 815 360**

This Hoist complies with and/or exceeds the requirements of the AS1418 Crane Code.

## Safety Inspection Programme Test Procedure

**Models L-12RLP, L-24RLP, RLP#3 & JRT**

**Date of inspection**

**Location.**

**Inspected by.**

### Visual Inspection.

Refer to components list & relevant drawing. Each drawing shows part(s) in "as you see it " style. Use these when performing inspection.

### Inspection Times

This procedure is to be performed at the regular vehicle service periods or at a period not exceeding 6 months.

PERFORM A FUNCTIONAL TEST ON THE JIB CRANE & COMPLETE THE FOLLOWING CHECKS:

**Mark:**            Tick = Satisfactory  
                         O = If repaired or adjusted  
                         X = If further work is required

| INSPECTION POINT   | CHECK REQUIRED   | MARK |
|--|--|------|
| Boom, jib extension & boom storage bracket.                      | Structural damage,   |      |
|  | Corrosion,   |      |
|  | Unauthorised modifications.  |      |
| Boom pivot pins, load support pins & plates, boom extension pin. | Wear,  |      |
|  | Damage,  |      |
|  | Substitution.  |      |
| Boom mounting base & hydraulic power pack mounting bolts.        | Missing bolts,   |      |
|  | Security, (tightening torque =            ) 12mm Mild steel bolts. |      |
|  | Damage.  |      |
| Hydraulic ram.   | Damage,  |      |
|  | Leaking seals,   |      |
| Flow control valve.  | Operation,   |      |
|  | Leaks.   |      |

Lindsell Hoists Freecall 1800 815 360

| INSPECTION POINT                       | CHECK REQUIRED   | MARK |
|--|--|------|
| Hydraulic hoses.                       | Leaks,   |      |
|  | Wear,  |      |
|  | Damage.  |      |
| Electric cables.                       | Damage,  |      |
|  | Secure connection.   |      |
| Handset controls.                      | Damage,  |      |
|  | Correct operation.   |      |
| Ratchet slew pin & gear teeth.         | Check for correct operation & security.<br>(consult manufacturer if further details are required). |      |
| Load hook.                             | Damage,  |      |
|  | Wear,  |      |
|  | Correct operation of safety latch,   |      |
|  | Measure hook gap, ( new condition = 10% increase allowable)  |      |
| Adjustable support leg & location pin. | Correct operation & stowage,   |      |
|  | Damage.  |      |
|  |  |      |
| Lifting Labels                         | 250 kg SWL Label Present<br>400 kg SWL Label Present<br>700 kg SWL Label Present                   |      |
|  | Damage   |      |
| Manufacturer Label                     | On Lindsell Hoist Base   |      |
|  | Damage   |      |

## Lindsell Hoists Customer Service

To order parts call Freecall 1800 815 360  
Alternatively Fax 03 5989 8811

## Warranty

All Lindsell Hoists are covered by two year warranty.  
Terms and Conditions apply.

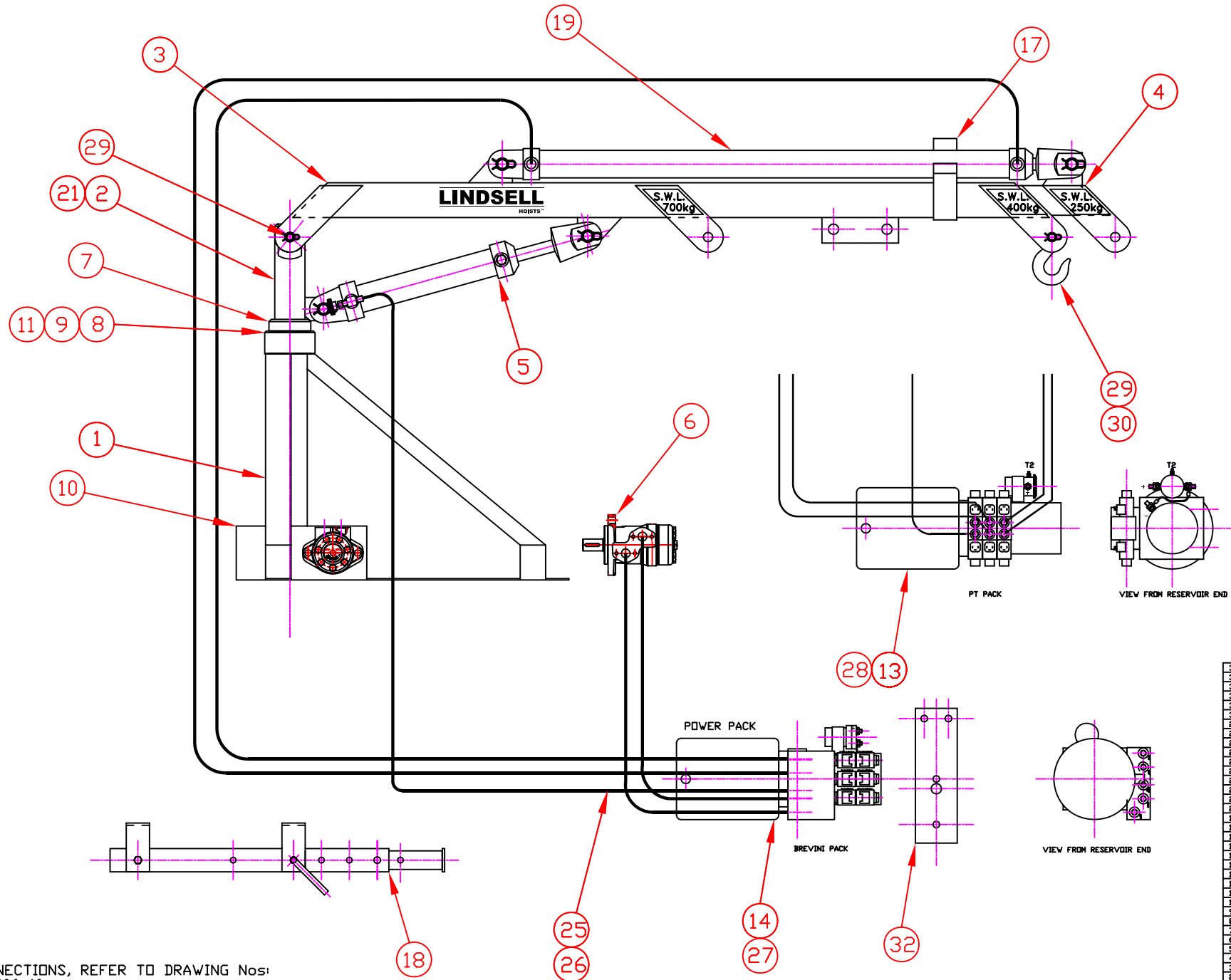

FOR HOSE CONNECTIONS, REFER TO DRAWING Nos:  
 PT PACK MLT-006-10  
 BREVINI PACK MLT-006-11

FOR ELECTRICAL CONNECTIONS, REFER TO DRAWING Nos:  
 PT PACK MLT-006-05  
 BREVINI PACK MLT-006-06

|      |                 |     |                    |          |
|------|-----------------|-----|--------------------|----------|
| 35   |                 |     |                    |          |
| 34   |                 |     |                    |          |
| 33   |                 |     |                    |          |
| 32   | POWER PACK MTG  | 1   | ML0830-06          |          |
| 31   |                 |     |                    |          |
| 30   | HOOK            | 1   | GHLESCOIN HOOKS    |          |
| 29   | PIN & CLIP      | 1   | MLT-002-30         |          |
| 28   | 6 BTN HANDSET   | 1   | MLT-006-07 BREVINI |          |
| 27   | 6 BTN HANDSET   | 1   | MLT-006-21 PT      |          |
| 26   | HOSE SET        | 1   | MLT-006-11 BREVINI |          |
| 25   | HOSE SET        | 1   | MLT-006-10 PT      |          |
| 24   |                 |     |                    |          |
| 23   |                 |     |                    |          |
| 22   |                 |     |                    |          |
| 21   | TOP BEARING     | 1   | MLT-002-21         |          |
| 20   |                 |     |                    |          |
| 19   | EXT CYLINDER    | 1   | MLT-004-01         |          |
| 18   | STABILISER LEG  | 1   | ML0830-05          |          |
| 17   | SUPPT LEG-CRANE | 1   | ML0830-06          |          |
| 16   | WIRING DIAGRAM  | 1   | MLT-006-06 PT      |          |
| 15   | WIRING DIAGRAM  | 1   | MLT-006-05 BREVINI |          |
| 14   | POWER PACK      | 1   | MLT-006-16 BREVINI |          |
| 13   | POWER PACK      | 1   | MLT-006-15 PT      |          |
| 12   |                 |     |                    |          |
| 11   | TOP BEARING     | 1   | 6208               |          |
| 10   | SLEW GEARBOX    | 1   | JRT-021            |          |
| 9    | TOP BUSH        | 1   | MLT-006-20         |          |
| 8    | PIVOT BLOCK     | 1   | MLT-006-09         |          |
| 7    | PIVOT COVER     | 1   | MLT-006-08         |          |
| 6    | SLEW MOTOR      | 1   | 151-0604 SDD       |          |
| 5    | LIFT CYLINDER   | 1   | MLT-002-05         |          |
| 4    | EXTENSION ARM   | 1   | MLT-004-17         |          |
| 3    | MAIN ARM        | 1   | MLT-004-16         |          |
| 2    | PIVOT           | 1   | MLT-006-04         |          |
| 1    | BASE            | 1   | MLT-006-03         |          |
| ITEM | DESCRIPTION     | QTY | DRAWING            | SUPPLIER |

|                           |         |
|---------------------------|---------|
| LINDSELL                  |         |
| PRECAL 1800 815 NO HOISTS |         |
| ASSEMBLY                  | DATE    |
| JRT UNIT                  | SCALE   |
|                           | MLT-006 |

**Lindsell Hoists Freecall 1800 815 360**

## **Non Destructive Test Lindsell Hoists**

This procedure should be carried out as follows:-

Mining and Industrial Usage: Every 10 Years

This procedure should be carried out by a person(s) with appropriate qualifications.

1. All welds checked with Rocol Advanced Flaw Detection Systems # 3 Pack Series  
Available from: Woodpark Rd Smithfield NSW 2164

Alternatively

2. Ultrasonic Non Destructive Test  
On All Welds ( According to ASA Standard )

Crane Usage:

Each unit has a Date of Manufacture Label eg: Unit Made October 1999

|       |
|-------|
| 10-99 |
|-------|

Warranty is two years from date of Manufacture. Terms and Conditions Apply.

Call Freecall 1800 815 360 for Customer Service  
General wear and tear are not covered by warranty.

Replacement Recommendations

A general rule to apply is that if in doubt in the condition of the part it is recommended the part be replaced.

Apply Australian Standards were applicable.

Part Replacement List

Parts should have an ID marking or number. If in doubt call Freecall 1800 815360.

**Customer Service: Freecall 1800 815 360**



# **Lindsell Hoists**™

[www.lindsellhoists.com.au](http://www.lindsellhoists.com.au)

Locked Bag 1  
Point Leo  
Victoria 3916

ABN 15 007 308 830

[lindsellhoists@bigpond.com](mailto:lindsellhoists@bigpond.com)

**Lindsell Hoists Freecall 1800 815 360**

This Hoist complies with and/or exceeds the requirements of the AS1418 Crane Code.

## **Lindsell Hoist Operating & Safety Procedure**

### ALL Models

1. Secure your load with correct sling or chain (fastening device).
2. Ensure vehicle is stabilised and ground surface safe. Check if not too soft.
3. Lift slowly and check visually for incorrect centre of gravity. ie. Will the load tip out of sling?
4. Use push button control to move load in desired direction. Know the control settings.
5. Stand clear of load.

Please call Freecall 1800 815 360 should you require any further assistance in operating a Lindsell Hoist.

## Your Lindsell Remote Control

- HOLD A and B Simultaneously until LED is GREEN
- 1 is UP                      3 is EXTEND                      5 is SLEW LEFT
- 2 is DOWN                    4 is RETRACT                      6 is Slew RIGHT



## Your Lindsell Remote Control has EMERGENCY PANEL

- HOLD A and B Simultaneously until LED is GREEN
- 1 is UP                      3 is EXTEND                      5 is SLEW LEFT
- 2 is DOWN                      4 is RETRACT                      6 is Slew RIGHT





Keep cover closed on your Remote Control Panel

